

**Agenda for Pre-Bid Site Tour  
Waco Subsite  
January 14, 2008**

Site Stop Number	General Location	Potential Site Features of Interest	Talking Points
1	North Entrance Gate	<ul style="list-style-type: none"> <li>- Site access from north</li> </ul>	<p>Introduce Mr. Doss (property owner for much of site). Describe south entrance which will not be part of site tour.</p>
2	North portion of Area A (former Butte Kansas)	<ul style="list-style-type: none"> <li>- Railroad embankment</li> <li>- Lily Pond</li> <li>- Waste topo/drainage</li> <li>- Chat piles; bullrock piles</li> <li>- Tree line along west edge</li> <li>- Remediation area by PRP</li> </ul>	<p>Show stop number 2 location on map. Point out Lily Pond has been drained since final drawings. Describe general limits of Area A. Describe general design concepts for Area A. Point out chat piles and bullrock piles to the south.</p>
3	Walk NE along RR embankment to view subsidence features	<ul style="list-style-type: none"> <li>- Existing RCP culverts</li> <li>- NW Pond</li> <li>- N Pond</li> </ul>	<p>Walk along railroad embankment to provide opportunity to view Lily Pond, existing culverts, and subsidence features.</p>
4	Southwest portion of Area A	<ul style="list-style-type: none"> <li>- Waste topography</li> <li>- Bullrock piles</li> <li>- Tree line along west edge</li> </ul>	<p>Brief stop to view southern portion of Area A.</p>
5	Northwest portion of Area B (Acme No. 1)	<ul style="list-style-type: none"> <li>- Site topo/drainage</li> <li>- Remnant of former RR spur</li> <li>- Tree line along west edge</li> </ul>	<p>Brief stop to view northwestern portion of Area B. Describe general limits of Area B. Describe general design concepts for Area B.</p>
6	Southwest portion of Area B	<ul style="list-style-type: none"> <li>- Site topo/drainage</li> <li>- Tree line along west edge</li> </ul>	<p>Brief stop to view southwestern portion of Area B.</p>
7	Northwest portion of Area C (Acme No. 2)	<ul style="list-style-type: none"> <li>- Tree line to north</li> <li>- Fence line to the west</li> <li>- Tires and debris</li> </ul>	<p>Describe general limits of Area C. Describe general design concepts for Area C. Point out tires and debris.</p>

8	Southeast portion of Area C	- Fence line to south and east - Remnants of Mill Fdns. - Remediation area by PRP	Describe interface between EPA and PRP work areas. Observe concrete mill works foundations. Observe tailings across area C.
9 (Optional)	Mine shaft – south area B	- Mine shaft	Walk to mine shaft if time allows.
10 (Optional)	Eastern perimeter of Area A	- Subsidence Pits A3 and A5	Park and walk into wooded area to view subsidence pits if time allows.
11 (Optional)	Eastern perimeter of Area B	- State line ponds - Mine shaft	Park and walk to view State line ponds and mine shaft with wood structure if time allows.



Limits of Work

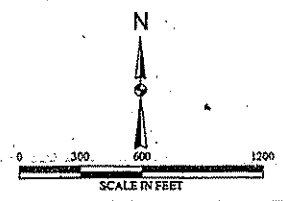

C:\GDI\Gardens\Waco\FinalDesign\BOD\LimitsofWork.dwg 08-30-07 2:11:11

Filename: C:\GDI\Gardens\Waco\FinalDesign\BOD\LimitsofWork.dwg  
 Task Order Number: 3370-014  
 Revised: 08/28/07 MMG  
 Source: Aerial Data Service, December 2006

Legend

--- Approximate Limits of Work

Figure 2.6  
 Limits of Work



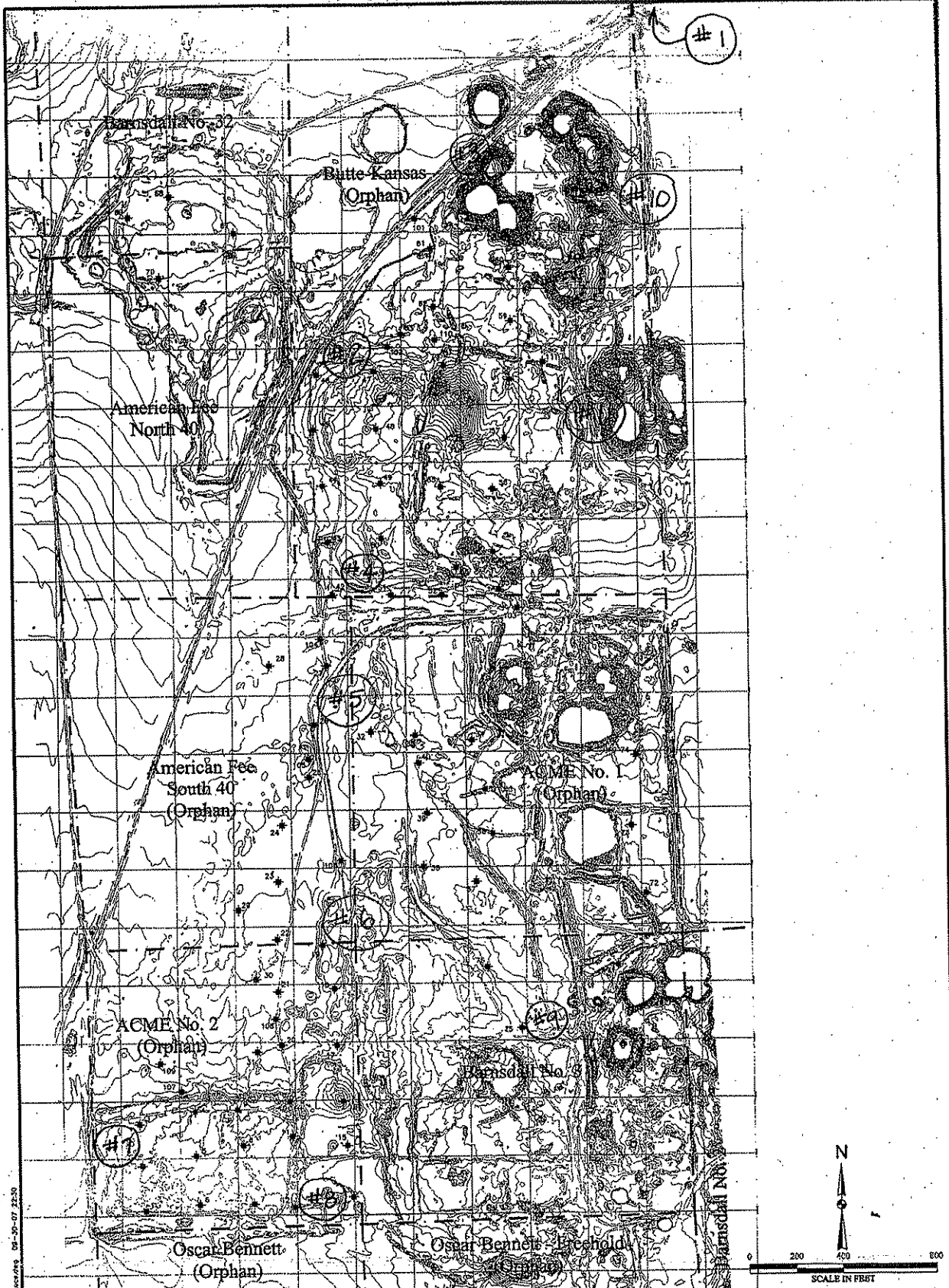

C:\CD\Cherokee\Waco\FinalDesign\BOD\TestPitLoc.dwg 06-29-07 2:30

Filename: C:\CD\Cherokee\Waco\FinalDesign\BOD\TestPitLoc.dwg  
 Task Order Number: 3370-014  
 Revised: 06/28/07 MMG  
 Source: Aerial Data Service, December 2006

- 12
- ◆ Test Pit Location
  - Lease Area Boundary

**Legend**

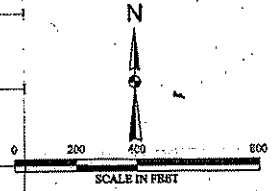

**Figure 2.4**  
**Test Pit Locations**



Test pit results can be found in Appendix A.