

# CONROE CREOSOTING (MONTGOMERY COUNTY) CONROE, TEXAS

**EPA REGION 6**  
**CONGRESSIONAL**  
**DISTRICT 08**



EPA ID# TXD008091951  
Site ID: 0601732

**Contacts:**  
**Gary Baumgarten 214-665-6749**

**Updated: December 2009**

## Current Status

---

EPA began the long-term ground water monitoring program in November 2005 to assess the natural attenuation of pentachlorophenol in the shallow aquifer at a depth of 60 feet below ground surface. The landfill at the Site is marked with signs, locked gates, and security fencing. The Texas Commission on Environmental Quality is currently assessing repairs to the landfill cover over the RCRA vault containing the contaminated soils and sediments from the site.

## Benefits

---

The removal action addressed contamination above health-based levels at on-site and off-site locations, including Stewart's Creek and off-site drainage areas. The ground water investigation determined that contamination from the facility has only impacted the ground water beneath the facility and is not a threat to the surrounding private water supply wells. The long-term monitoring program will continue to monitor the contaminant levels in ground water.

## National Priorities Listing (NPL) History

---

NPL Inclusion Proposal Date: April 30, 2003  
NPL Inclusion Final Date: September 22, 2003

## Site Description

---

The Site is located in Conroe, Montgomery County, approximately 30 miles north of Houston, Texas. Approximately 15,000 people live within two miles of the site. The site consists of 147 acres and is a former wood treating facility. There is a residential community to the east, a wooded area to the north, and commercial activities to the west and south. The shallow water-bearing zone is 60 feet deep and is currently not being used. The first water-bearing zone used for domestic supply is 125 feet deep. The City of Conroe water supply is 400 to 1000 feet below the surface.

## Wastes and Volumes

---

Approximately 252,000 cubic yards of soils exceeded the EPA Region 6 Human Health Medium-Specific Screening Levels for either arsenic, chromium, pentachlorophenol, total creosote compounds, or dioxin and furans and were placed in the site RCRA vault during the emergency response action. The cleanup goal for pentachlorophenol (PCP) in the ground water is 1 part per billion (ppb).

## Record of Decision (ROD)

---

A Final Record of Decision was signed on September 29, 2003.

## Site Contacts

---

EPA Remedial Project Manager:	Gary Baumgarten	214-665-6749
EPA Site Attorney:	Barbara Nann	214-665-2157
EPA Regional Public Liaison:	Donn Walters	214-665-6483
TCEQ Project Manager	Jeff Patterson	512-239-2489

EPA Superfund Region 6 Toll Free Number: 1-800-533-3508

**Information Repository:** Montgomery County Memorial Library, 104 I-45 North, Conroe, TX 77301, (936) 539-7814

## Site Map

---

The following map illustrates the site location on the east side of Conroe, Texas.

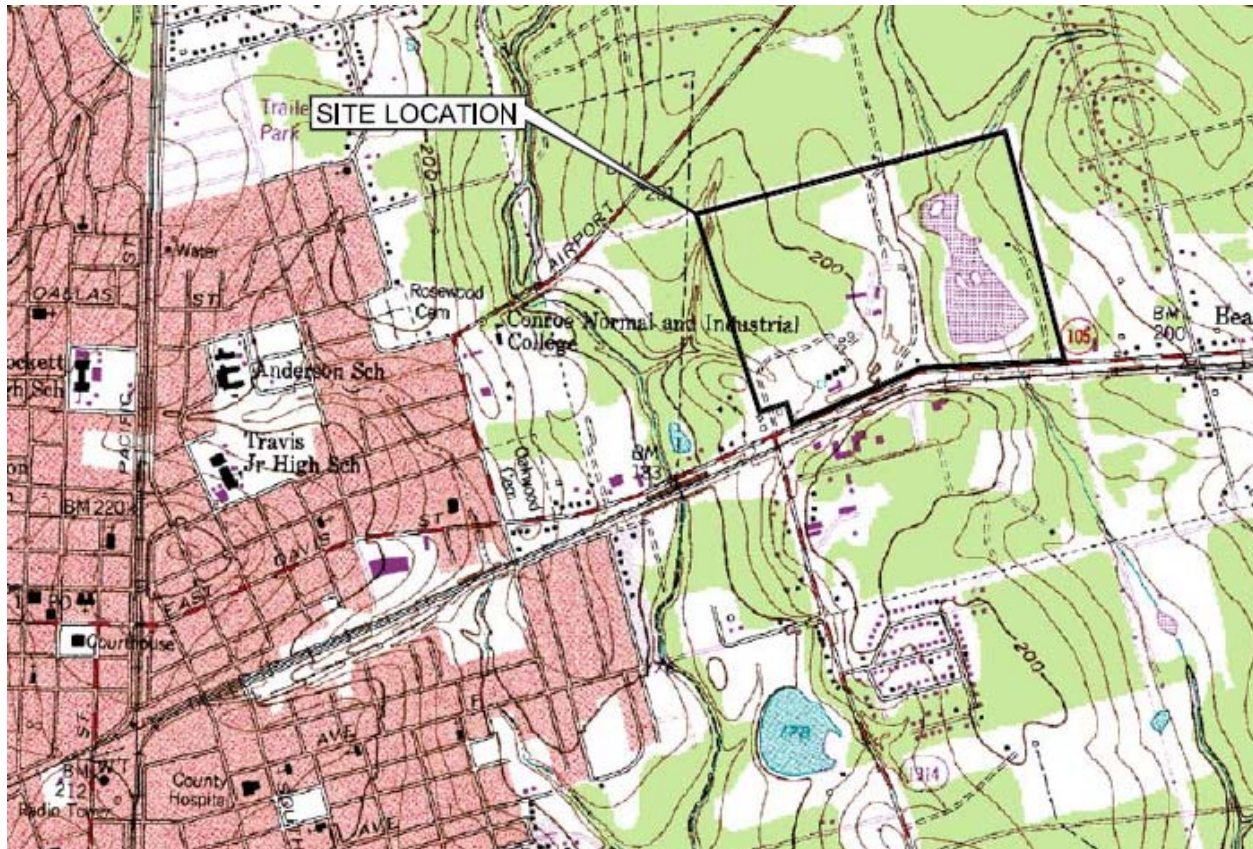

The following site map illustrates the PCP contamination based on the October 2006 ground water sample data. PCP concentrations are shown in red and are in micrograms per liter ( $\mu\text{g/L}$ ).

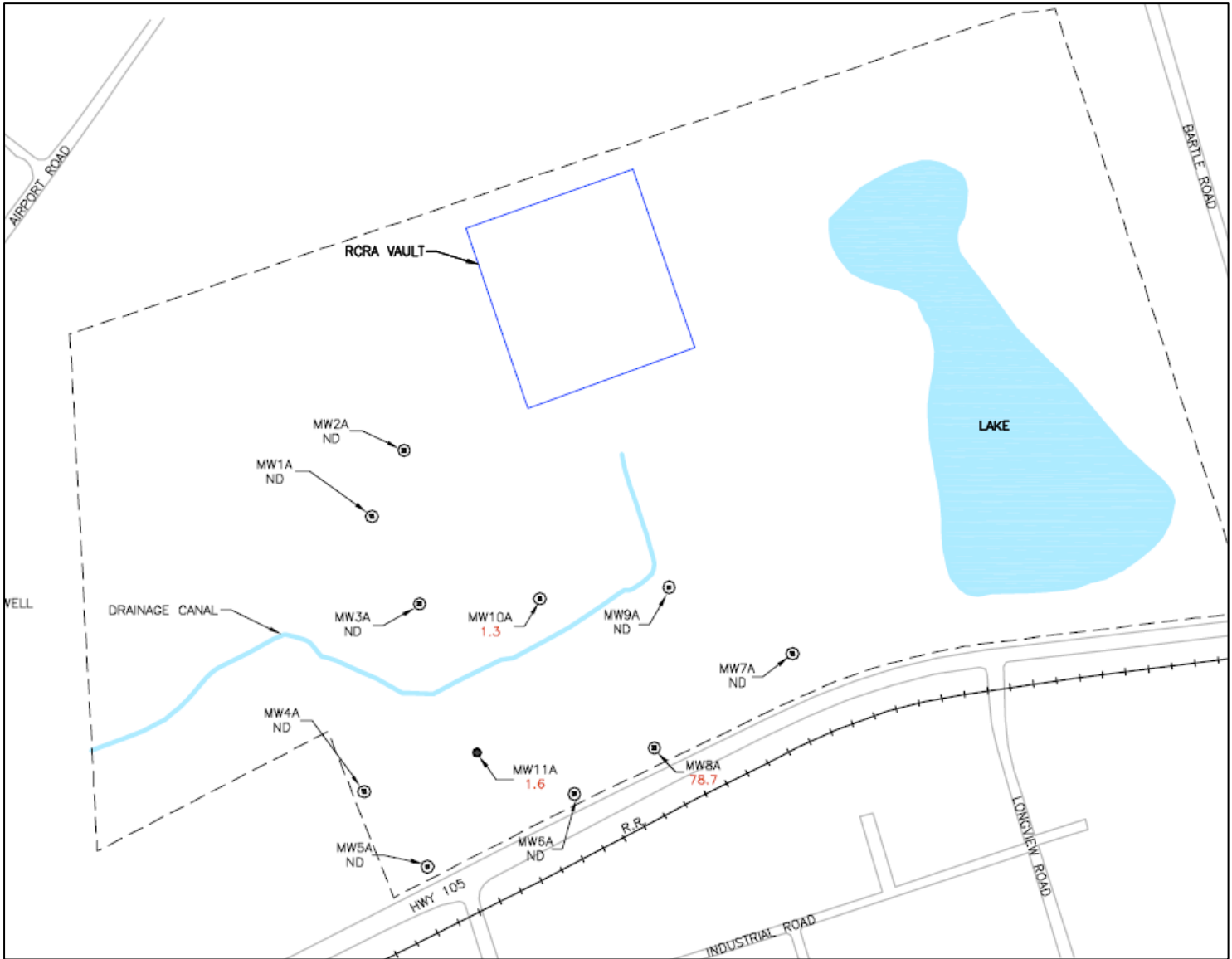

- ⊕ SAND-1 SHALLOW MONITORING WELL
- SHALLOW MONITORING WELL
- 78.7 PENTACHLOROPHENOL CONCENTRATION ( $\mu\text{g/L}$ )
- ND PENTACHLOROPHENOL NOT DETECTED ABOVE REPORTING LIMIT (1.0  $\mu\text{g/L}$ )