

FIGURE 2-1, JUNE/JULY 1996  
 SUBSURFACE SOIL BORING LOCATIONS  
 REMEDIAL INVESTIGATION REPORT  
 NORTH BELMONT PCE SUPERFUND SITE  
 NORTH BELMONT, GASTON COUNTY, NC  
 SEDS PROJECT No. 96S-058, JUNE 1997

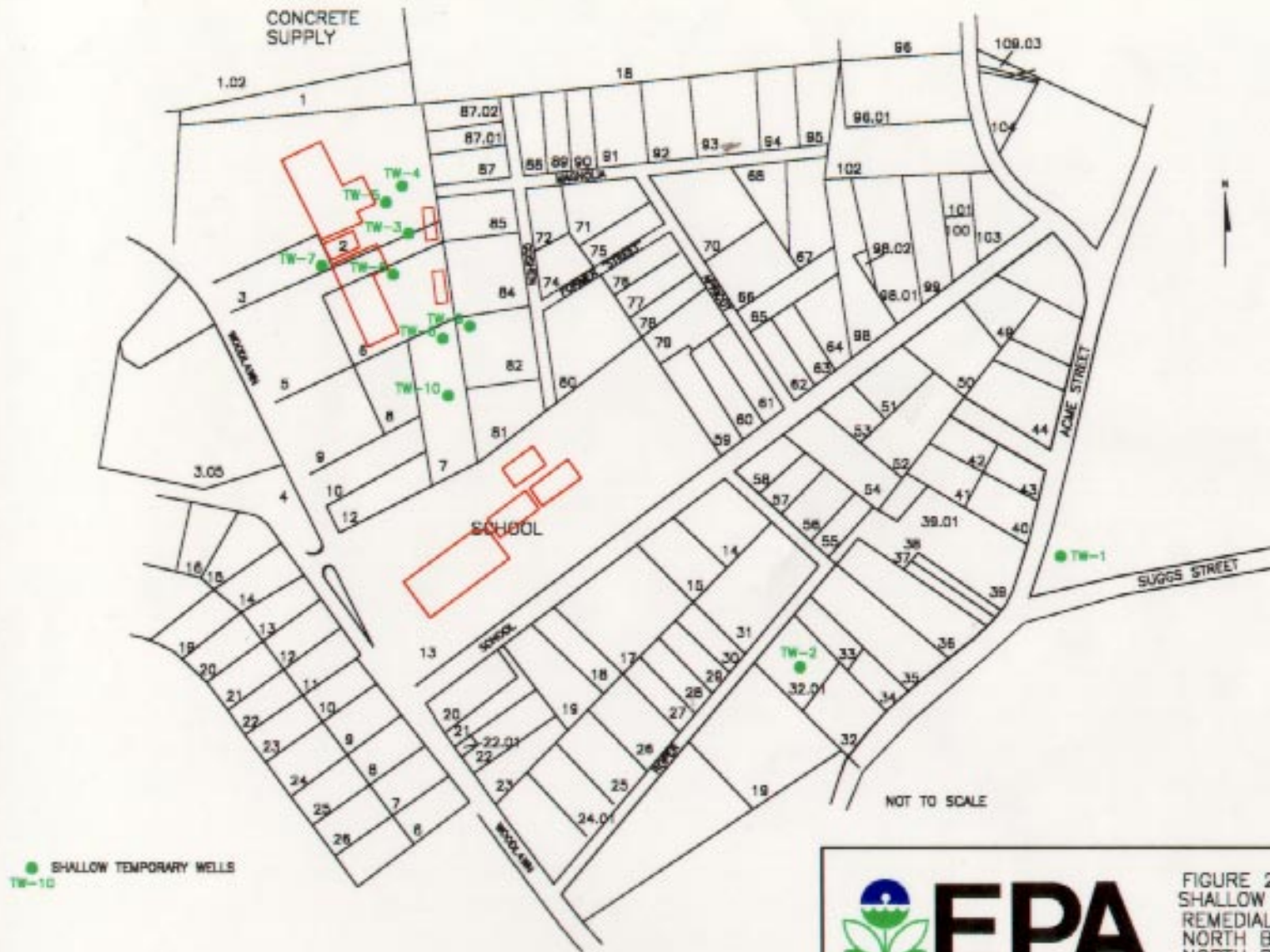
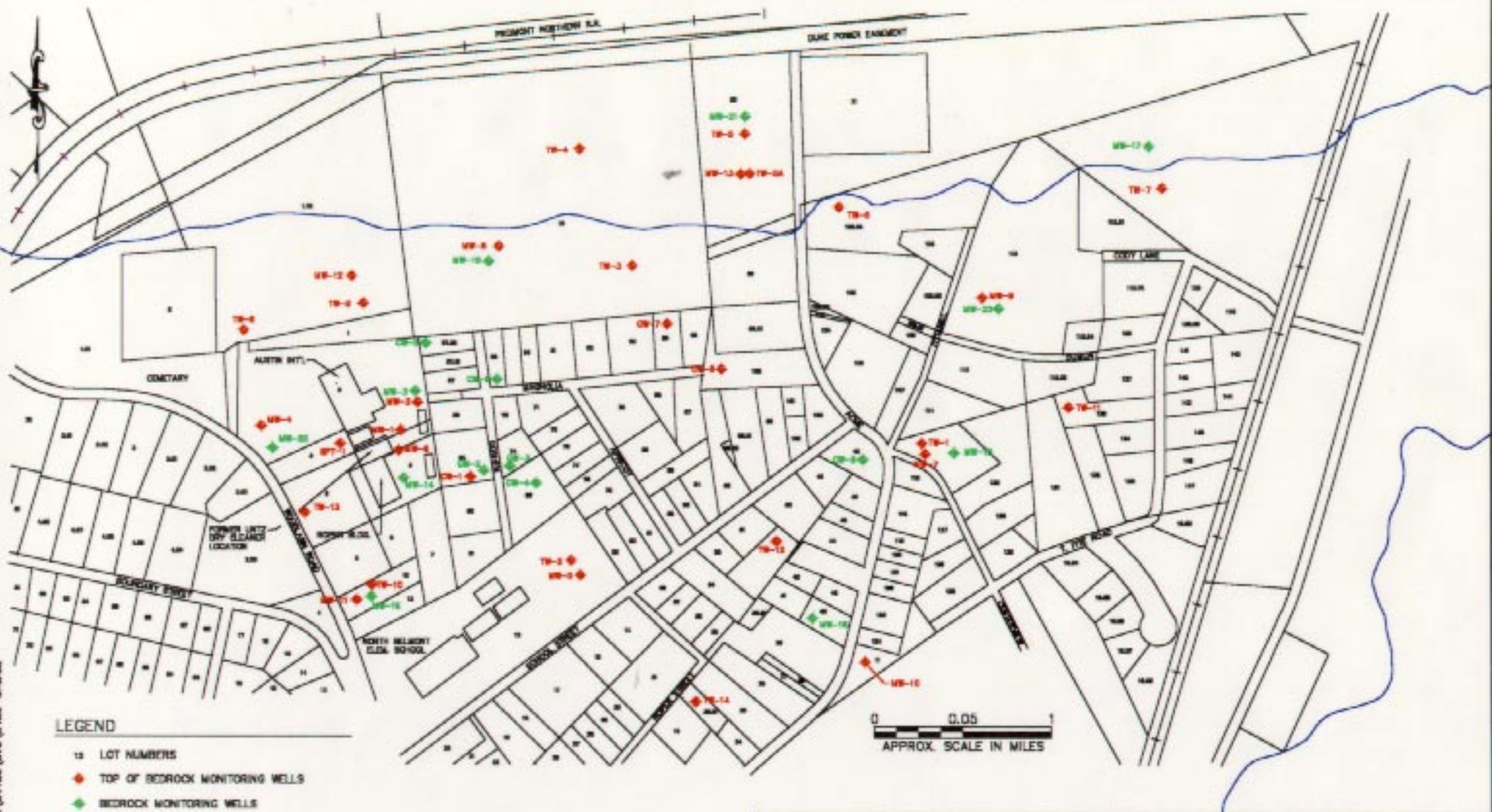

FIGURE 2-2, JUNE 1996  
SHALLOW TEMPORARY WELL LOCATIONS  
REMEDIAL INVESTIGATION REPORT  
NORTH BELMONT PCE SUPERFUND SITE  
NORTH BELMONT, GASTON COUNTY, NC  
SESD PROJECT No. 96S-058, JUNE 1997





**LEGEND**

- 12 LOT NUMBERS
- ◆ TOP OF BEDROCK MONITORING WELLS
- ◆ BEDROCK MONITORING WELLS



FIGURE 2-3, TOP OF ROCK TEMPORARY WELLS AND PERMANENT MONITORING LOCATIONS, JULY/AUGUST 1996  
 REMEDIAL INVESTIGATION REPORT  
 NORTH BELMONT PCE SUPERFUND SITE  
 NORTH BELMONT, GASTON COUNTY, NC  
 SESD PROJECT No. 96S-058, JUNE 1997



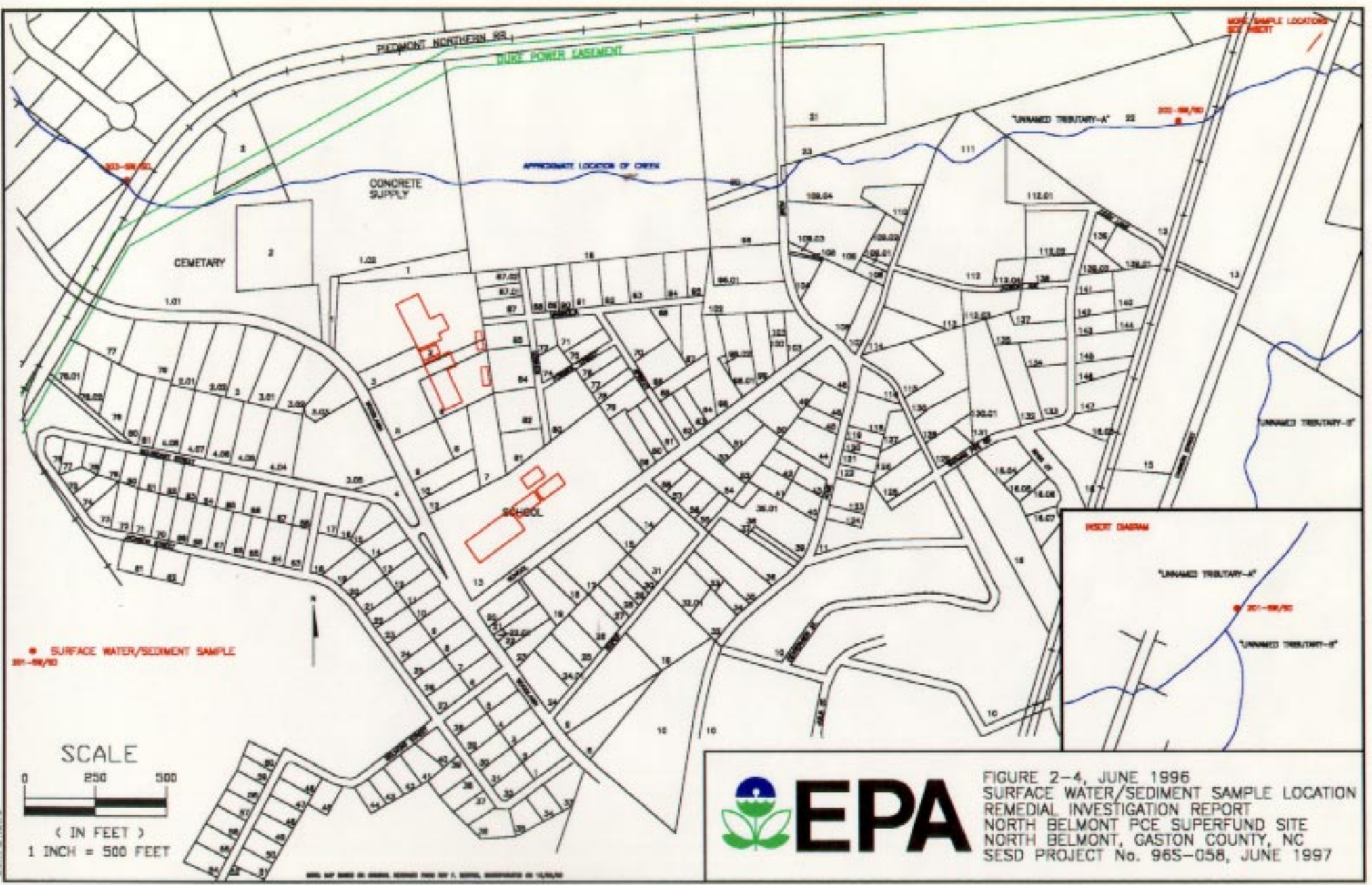

● SURFACE WATER/SEDIMENT SAMPLE  
 95-96/92

**SCALE**  
 0 250 500  
 ( IN FEET )  
 1 INCH = 500 FEET



FIGURE 2-4, JUNE 1996  
 SURFACE WATER/SEDIMENT SAMPLE LOCATION  
 REMEDIAL INVESTIGATION REPORT  
 NORTH BELMONT PCE SUPERFUND SITE  
 NORTH BELMONT, GASTON COUNTY, NC  
 SESD PROJECT No. 96S-058, JUNE 1997





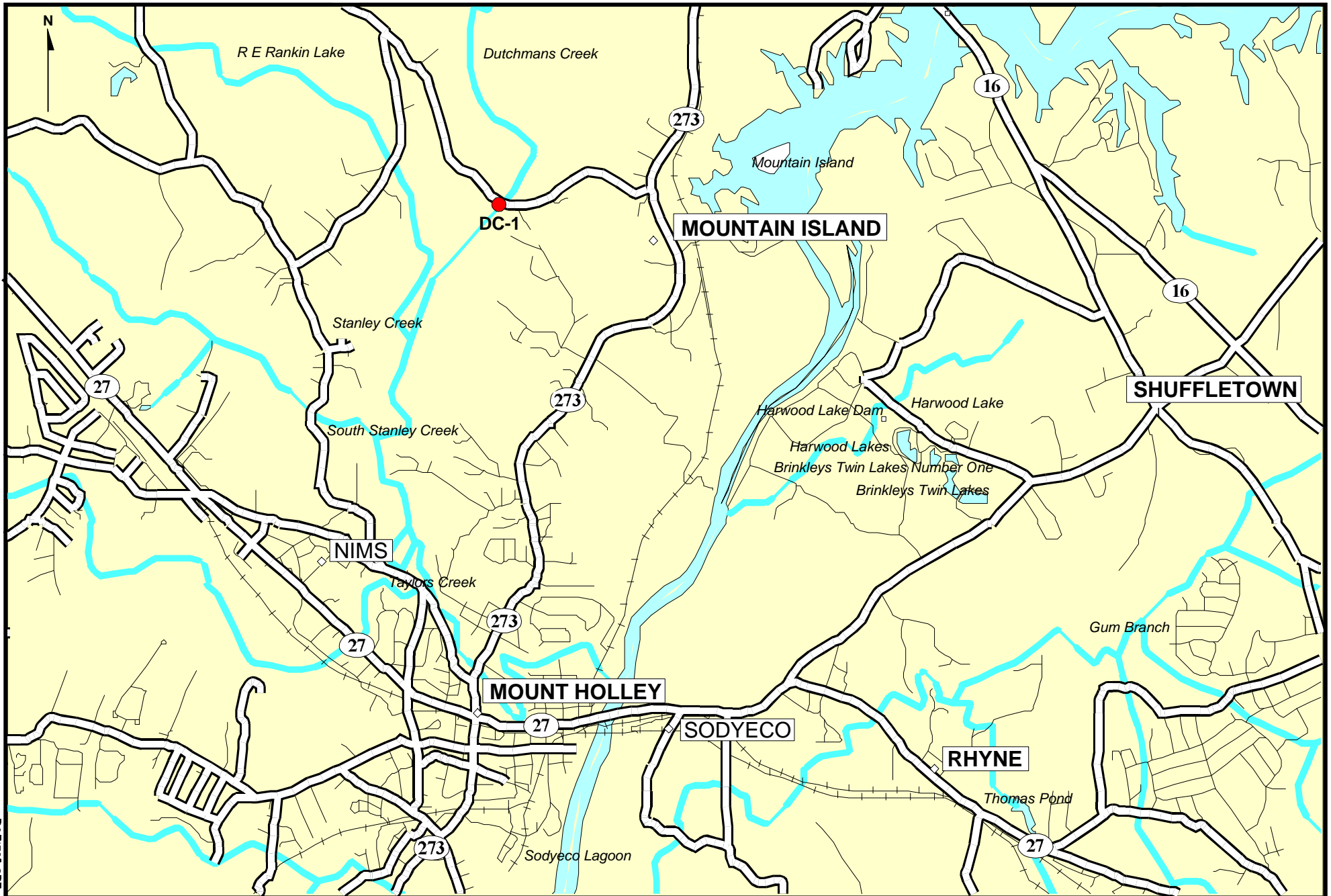

D&R/F&B CDR

SOURCE: DeLORME MAP EXPERT

● SAMPLE LOCATION



**FIGURE 2-6** REFERENCE SITE, DUTCHMANS CREEK  
 REMEDIAL INVESTIGATION REPORT  
 NORTH BELMONT PCE SUPERFUND SITE  
 NORTH BELMONT, GASTON COUNTY, NC  
 SESD PROJECT No. 96S-058, JUNE 1997

NOT TO SCALE