



CLASS II

UNITED STATES ENVIRONMENTAL PROTECTION AGENCY  
WASHINGTON, DC 20460

ANNUAL DISPOSAL/INJECTION WELL MONITORING REPORT

NAME AND ADDRESS OF EXISTING PERMITTEE

Curtis Oil Inc.  
PO Box 287  
Duke Center PA 16729

NAME AND ADDRESS OF SURFACE OWNER

James Tingley ETAL  
36 Bedford St.  
Bradford PA 16701

LOCATE WELL AND OUTLINE UNIT ON SECTION PLAT - 640 ACRES

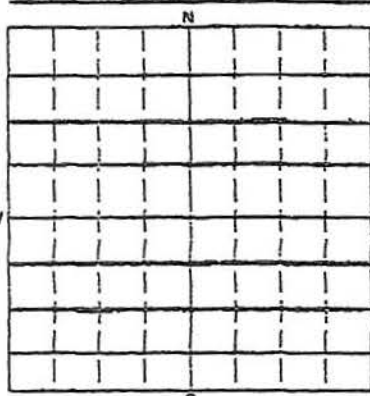

STATE

PA

COUNTY

McKean

PERMIT NUMBER

PA52R 902Bmck

SURFACE LOCATION DESCRIPTION

1/4 OF

1/4 OF

1/4 SECTION

Lafayette

TOWNSHIP

RANGE

LOCATE WELL IN TWO DIRECTIONS FROM NEAREST LINES OF QUARTER SECTION AND DRILLING UNIT

Surface

Location R. from (N/S) Line of quarter section

and ft. from (E/W) Line of quarter section

WELL ACTIVITY

TYPE OF PERMIT

- Brine Disposal
- Enhanced Recovery
- Hydrocarbon Storage

- Individual
- Area
- Number of Wells 19

RECEIVED  
EPA REGION III  
JAN 23 2019  
GROUND WATER & ENFORCEMENT  
(3WP22)

Lease Name

Bullymore

Well Number

NO-188

Monitoring Location:

(if manifold monitoring)

well site

Nature of Injection Fluid

produced Brine water

INJECTION PRESSURE

TOTAL VOLUME INJECTED

FLOW RATE  
(BBL/Day)

MONTH	YEAR	AVERAGE PSIG	MAXIMUM PSIG	BBL	NCF	AVERAGE	MAXIMUM
1-	2018	680	690	700		22.58	
2-	2018	675	685	640		22.85	
3-	2018	645	660	710		22.90	
4-	2018	650	665	695		23.16	
5-	2018	720	735	690		22.25	
6-	2018	690	700	700		23.33	
7-	2018	675	680	685		22.09	
8-	2018	670	675	675		21.77	
9-	2018	660	675	670		22.33	
10-	2018	690	705	680		21.93	
11-	2018	680	710	670		22.33	
12-	2018	695	705	665		21.45	

CERTIFICATION

I certify under the penalty of law that I have personally examined and am familiar with the information submitted in this document and all attachments and that, based on my inquiry of those individuals immediately responsible for obtaining the information, I believe that the information is true, accurate, and complete. I am aware that there are significant penalties for submitting false information, including the possibility of fine and imprisonment. (Ref. 40 CFR 144.32).

NAME AND OFFICIAL TITLE (Please type or print)

Randy W. Curtis  
President

SIGNATURE

*Randy W. Curtis*

DATE SIGNED

1-21-2019



CLASS II

UNITED STATES ENVIRONMENTAL PROTECTION AGENCY  
WASHINGTON, DC 20460

ANNUAL DISPOSAL/INJECTION WELL MONITORING REPORT

NAME AND ADDRESS OF EXISTING PERMITTEE

NAME AND ADDRESS OF SURFACE OWNER

Curtis Oil Inc.  
PO Box 287  
Duke Center PA 16729

James Tingley ETAL  
36 Bedford St  
Bradford PA 16701

LOCATE WELL AND OUTLINE UNIT ON SECTION FLAT - 640 ACRES

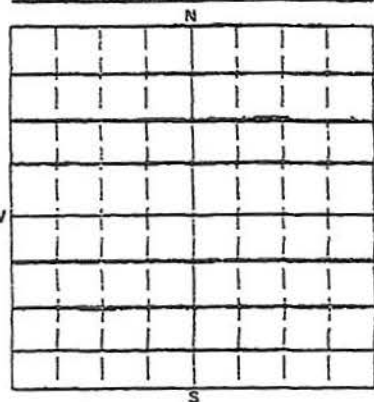

STATE PA COUNTY McKean

PERMIT NUMBER PAS2R902Bmck

SURFACE LOCATION DESCRIPTION

1/4 OF 1/4 SECTION Lafayette TOWNSHIP RANGE

LOCATE WELL IN TWO DIRECTIONS FROM NEAREST LINES OF QUARTER SECTION AND DRILLING UNIT

Surface Location R. from (N/S) Line of quarter section  
and ft. from (E/W) Line of quarter section

WELL ACTIVITY TYPE OF PERMIT

- Brine Disposal
- Enhanced Recovery
- Hydrocarbon Storage
- Individual Area
- Number of Wells 19

Lease Name Well Number NO-218

Monitoring Location: (if manifold monitoring) wellsite

Nature of Injection Fluid produced Brine water

RECEIVED  
EPA REGION III  
JAN 23 2019  
GROUND WATER & ENFORCEMENT  
(3WP22)

INJECTION PRESSURE

TOTAL VOLUME INJECTED

FLOW RATE (BBL/Day)

MONTH	YEAR	AVERAGE PSIG	MAXIMUM PSIG	BBL	MCF	AVERAGE	MAXIMUM
1	2018	680	696	1280		41.29	
2	2018	675	685	1295		46.25	
3	2018	645	660	1300		41.93	
4	2018	656	665	1305		43.50	
5	2018	720	735	1290		41.61	
6	2018	690	700	1310		43.66	
7	2018	675	680	1290		41.61	
8	2018	670	675	1275		41.12	
9	2018	660	675	1260		42.00	
10	2018	690	705	1295		41.77	
11	2018	680	710	1315		43.83	
12	2018	695	705	1305		42.09	

CERTIFICATION

I certify under the penalty of law that I have personally examined and am familiar with the information submitted in this document and all attachments and that, based on my inquiry of those individuals immediately responsible for obtaining the information, I believe that the information is true, accurate, and complete. I am aware that there are significant penalties for submitting false information, including the possibility of fine and imprisonment. (Ref. 40 CFR 144.32).

NAME AND OFFICIAL TITLE (Please type or print)

SIGNATURE

DATE SIGNED

Kandy W CURTIS  
President

*Kandy W Curtis*

1-31-2019

P-MAX=800

Total bbls = 15520

Compliance done Completed  
WAMS updated  
DPT for 6:00 am 2/14/19



CLASS II

UNITED STATES ENVIRONMENTAL PROTECTION AGENCY  
WASHINGTON, DC 20460

ANNUAL DISPOSAL/INJECTION WELL MONITORING REPORT

NAME AND ADDRESS OF EXISTING PERMITTEE

CURTIS Oil Inc.  
PO BOX 287  
Duke Center PA 16729

NAME AND ADDRESS OF SURFACE OWNER

James Tingley ETAL  
36 Bedford St  
Bradford PA 16729

LOCATE WELL AND OUTLINE UNIT ON SECTION PLAT - 640 ACRES

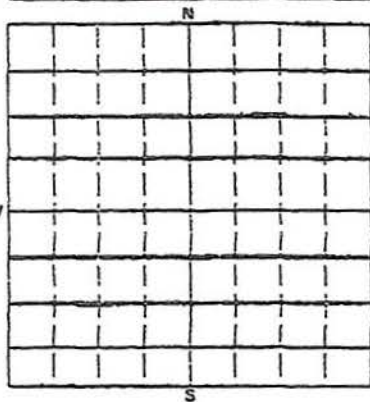

STATE PA COUNTY McKean PERMIT NUMBER PA52R9020MDK

SURFACE LOCATION DESCRIPTION 1/4 OF 1/4 OF 1/4 SECTION Lafayette TOWNSHIP RANGE

LOCATE WELL IN TWO DIRECTIONS FROM NEAREST LINES OF QUARTER SECTION AND DRILLING UNIT  
Surface Location R. from (N/S) Line of quarter section  
and ft. from (E/W) Line of quarter section

WELL ACTIVITY TYPE OF PERMIT  
 Brine Disposal  Individual  
 Enhanced Recovery  Area  
 Hydrocarbon Storage Number of Wells 19

Lease Name Bullymore Well Number NO-219

Monitoring Location (if manifold monitoring) well site

Nature of Injection Fluid produced brine water

RECEIVED  
EPA REGION III  
JAN 28 2019  
GROUND WATER ENFORCEMENT  
(3WV22)

INJECTION PRESSURE TOTAL VOLUME INJECTED FLOW RATE (BBL/Day)

MONTH	YEAR	AVERAGE PSIG	MAXIMUM PSIG	BBL	NCF	AVERAGE	MAXIMUM
1	2018	680	690	640		20.64	
2	2018	675	685	545		19.46	
3	2018	645	660	645		20.80	
4	2018	650	665	620		20.66	
5	2018	720	735	610		19.67	
6	2018	690	700	595		19.83	
7	2018	675	680	590		19.03	
8	2018	670	675	625		20.16	
9	2018	660	675	595		19.83	
10	2018	690	705	530		17.09	
11	2018	680	710	600		20.00	
12	2018	695	705	585		18.87	

CERTIFICATION

I certify under the penalty of law that I have personally examined and am familiar with the information submitted in this document and all attachments and that, based on my inquiry of those individuals immediately responsible for obtaining the information, I believe that the information is true, accurate, and complete. I am aware that there are significant penalties for submitting false information, including the possibility of fine and imprisonment. (Ref. 40 CFR 144.32).

NAME AND OFFICIAL TITLE (Please type or print)

Randy W. Curtis  
President

SIGNATURE

Randy W. Curtis

DATE SIGNED

1-21-2019

P-max = 800

Total bbls = 7180

Compliance Review Complete  
MMS updated  
Ref: to E: Deme Du. shd. a



CLASS II

UNITED STATES ENVIRONMENTAL PROTECTION AGENCY  
WASHINGTON, DC 20460

ANNUAL DISPOSAL/INJECTION WELL MONITORING REPORT

NAME AND ADDRESS OF EXISTING PERMITTEE

CURTIS OIL INC  
PO BOX 287  
Duke Center PA 16729

NAME AND ADDRESS OF SURFACE OWNER

James Ingleby ETAL  
36 Bedford St.  
Bedford PA 16701

LOCATE WELL AND OUTLINE UNIT ON SECTION PLAT - 640 ACRES

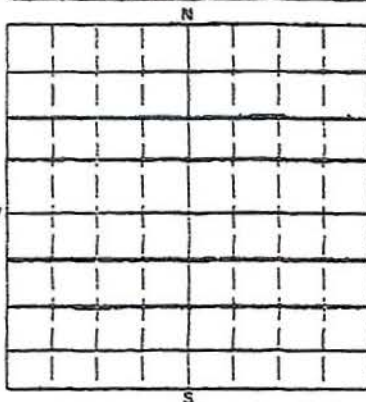

STATE PA COUNTY McKean

PERMIT NUMBER PAS 2R962BMCK

SURFACE LOCATION DESCRIPTION  
1/4 OF 1/4 OF 1/4 SECTION Lafayette TOWNSHIP RANGE

LOCATE WELL IN TWO DIRECTIONS FROM NEAREST LINES OF QUARTER SECTION AND DRILLING UNIT

Surface Location R. from (N/S) Line of quarter section  
and ft. from (E/W) Line of quarter section

WELL ACTIVITY TYPE OF PERMIT  
 Brine Disposal  Individual  
 Enhanced Recovery  Area  
 Hydrocarbon Storage Number of Wells 19

Lease Name Bullymore Well Number BMW3

Monitoring Location (if manifold monitoring) well site

Nature of Injection Fluid produced Brine water

JAN 29 2019  
GROUND WATER MONITORING (3WP22)

INJECTION PRESSURE TOTAL VOLUME INJECTED FLOW RATE (BBL/Day)

MONTH	YEAR	AVERAGE PSIG	MAXIMUM PSIG	BBL	MCF	AVERAGE	MAXIMUM
1	2018	150	150	1545		49.83	
2	2018	150	150	1550		55.35	
3	2018	150	150	1560		50.32	
4	2018	150	150	1490		49.66	
5	2018	180	180	1540		49.67	
6	2018	180	180	1535		51.16	
7	2018	180	180	1565		50.48	
8	2018	180	180	1530		49.35	
9	2018	200	200	1525		50.83	
10	2018	200	200	1545		49.83	
11	2018	250	250	1550		51.66	
12	2018	250	250	1500		48.38	

CERTIFICATION

I certify under the penalty of law that I have personally examined and am familiar with the information submitted in this document and all attachments and that, based on my inquiry of those individuals immediately responsible for obtaining the information, I believe that the information is true, accurate, and complete. I am aware that there are significant penalties for submitting false information, including the possibility of fine and imprisonment. (Ref. 40 CFR 144.32).

NAME AND OFFICIAL TITLE (please type or print)

Randy W. Curtis  
President

SIGNATURE

Randy W. Curtis

DATE SIGNED

1-21-2019

P-MAX=800

Total bbls = 18435

Compliance Review Completed  
w/mis updated  
Ddt to G. D. R. ne Pam 2/14/0



CLASS II

UNITED STATES ENVIRONMENTAL PROTECTION AGENCY  
WASHINGTON, DC 20460

ANNUAL DISPOSAL/INJECTION WELL MONITORING REPORT

NAME AND ADDRESS OF EXISTING PERMITTEE: **CURTIS OIL INC.**  
PO BOX 287  
DUKE CENTER PA 16729

NAME AND ADDRESS OF SURFACE OWNER: **James Tingley ETAL**  
36 Bedford St  
Bradford PA 16701

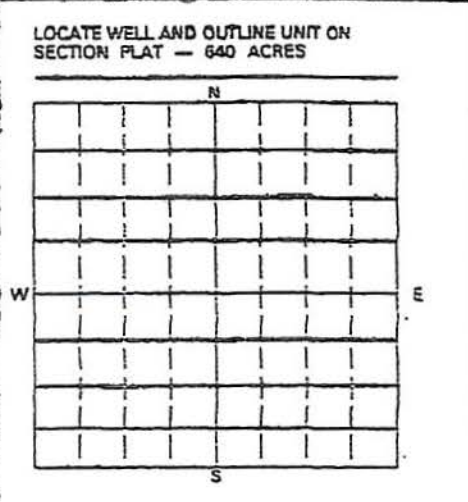

STATE: **PA** COUNTY: **McKean** PERMIT NUMBER: **PAS2R902BMCK**

SURFACE LOCATION DESCRIPTION: **Lafayette** TOWNSHIP RANGE

LOCATE WELL IN TWO DIRECTIONS FROM NEAREST LINES OF QUARTER SECTION AND DRILLING UNIT

Surface Location: **0** R. from (N/S) **0** Line of quarter section  
and **0** ft. from (E/W) **0** Line of quarter section

WELL ACTIVITY:  Brine Disposal  Enhanced Recovery  Hydrocarbon Storage

TYPE OF PERMIT:  Individual  Area  
Number of Wells: **19**

Lease Name: **Bullmore** Well Number: **BMW2**

RECEIVED UNIT  
EPA REGION III  
JAN 28 2019  
GROUND WATER ENFORCEMENT  
(3WP22)

Monitoring Location: (if manifold monitoring): **wellsite**

Nature of Injection Fluid: **produced Brine water**

MONTH	YEAR	INJECTION PRESSURE		TOTAL VOLUME INJECTED		FLOW RATE (BBL/Day)	
		AVERAGE PSIG	MAXIMUM PSIG	BBL	MCF	AVERAGE	MAXIMUM
1-2018		0	0	1305		42.09	
2-2018		0	0	995		35.53	
3-2018		0	0	1375		44.35	
4-2018		0	0	1400		46.66	
5-2018		0	0	1390		44.83	
6-2018		0	0	1385		46.16	
7-2018		0	0	1410		45.48	
8-2018		0	0	1420		45.80	
9-2018		0	0	1435		47.83	
10-2018		50	50	1410		45.48	
11-2018		150	150	1390		46.33	
12-2018		150	150	1375		44.35	

**CERTIFICATION**

I certify under the penalty of law that I have personally examined and am familiar with the information submitted in this document and all attachments and that, based on my inquiry of those individuals immediately responsible for obtaining the information, I believe that the information is true, accurate, and complete. I am aware that there are significant penalties for submitting false information, including the possibility of fine and imprisonment. (Ref. 40 CFR 144.32).

NAME AND OFFICIAL TITLE (Please type or print): **Randy Curtis**  
**President**

SIGNATURE: *Randy Curtis*

DATE SIGNED: **1-21-2019**