

**EXHIBIT K**

HGAC Closed Landfill Inventory Maps





**Site ID:** 1310  
**County:** Waller  
**Site Name:** Prairie View A&M University

**Location:** N part of Prairie View, on S side of FM 1093, and in NW part of Prairie View A&M University

**Key Map Page:**

**Classification:** Municipal I

**Related Sites:** No

**INFORMATION OBTAINED**

- |                     |                                     |                     |                                     |                          |                                     |
|---------------------|-------------------------------------|---------------------|-------------------------------------|--------------------------|-------------------------------------|
| <b>TNRCC Files</b>  | <input checked="" type="checkbox"/> | <b>Landfill Map</b> | <input checked="" type="checkbox"/> | <b>Aerials</b>           | <input checked="" type="checkbox"/> |
| <b>Fire Ins Map</b> | <input type="checkbox"/>            | <b>Affidavit</b>    | <input checked="" type="checkbox"/> | <b>City Directory</b>    | <input type="checkbox"/>            |
| <b>Survey Map</b>   | <input type="checkbox"/>            | <b>Unit Map</b>     | <input type="checkbox"/>            | <b>Health Dept Files</b> | <input type="checkbox"/>            |
| <b>Photos</b>       | <input type="checkbox"/>            | <b>Inspection</b>   | <input checked="" type="checkbox"/> | <b>Legal Description</b> | <input checked="" type="checkbox"/> |

**Data Gap Actions:** Uncertain about operation dates.

**SITE INFORMATION**

**Acreage:** 18

**Acreage Estimate:**

**Waste Types:** Brush, construction/demo, household, sludge, compound powder/dust, asbestos

**Research Suspended?**

**Date First Used:** 5/23/1980

**Date Last Used:** 7/1/1993

**OWNER INFORMATION**

**Land Owners:** Parcel Number A325400 A-254 Solomon Smith, Tract 1 Ac 315.8712  
Owner Name: Prairie View A&M University, Texas A&M Univ System  
Address: 319 System Building, College Station, TX 77843

**On-Line Data Address:** www.bccountydata.com

**Date Data Obtained:** 8/5/2002

**Land Use:** Closed landfill

**Adjacent Land Use:** Vacant (woods)

**Observations:** Lots of trash cans filled

**Date Visited:** 11/30/2000

**BOUNDARY INFORMATION**

**Exact Boundaries Known?**

**Boundary Info Source:** Affidavit

**Confidence Level:** Good Approximation

**Boundary Description:** Affidavit in file

**Special Notes:**

**Removal Notes:**

# Houston-Galveston Area Council Closed Landfill Inventory

**U699**  
**WALLER County**  
 Prepared on 18 JUL 2003

**Disclaimer:**  
 This Closed or Abandoned Municipal Solid Waste Landfill Inventory was prepared from information furnished by the Texas Commission on Environmental Quality ("TCEQ"), permitting records on file with TCEQ and the Texas Department of Health, and from aerial photography and GIS data developed by the Houston-Galveston Area Council ("H-GAC"). The county map, individual site maps, and legal descriptions of the closed or abandoned municipal solid waste landfills represent TCEQ's and H-GAC's best judgment about the landfills' location, but neither TCEQ nor H-GAC warrants the accuracy, timeliness, or completeness of the maps or legal descriptions. Moreover, because TCEQ and H-GAC have inventoried only known municipal solid waste landfills, TCEQ and H-GAC make no representation about whether a specific tract of land may overlie an unknown municipal or other solid waste landfill.

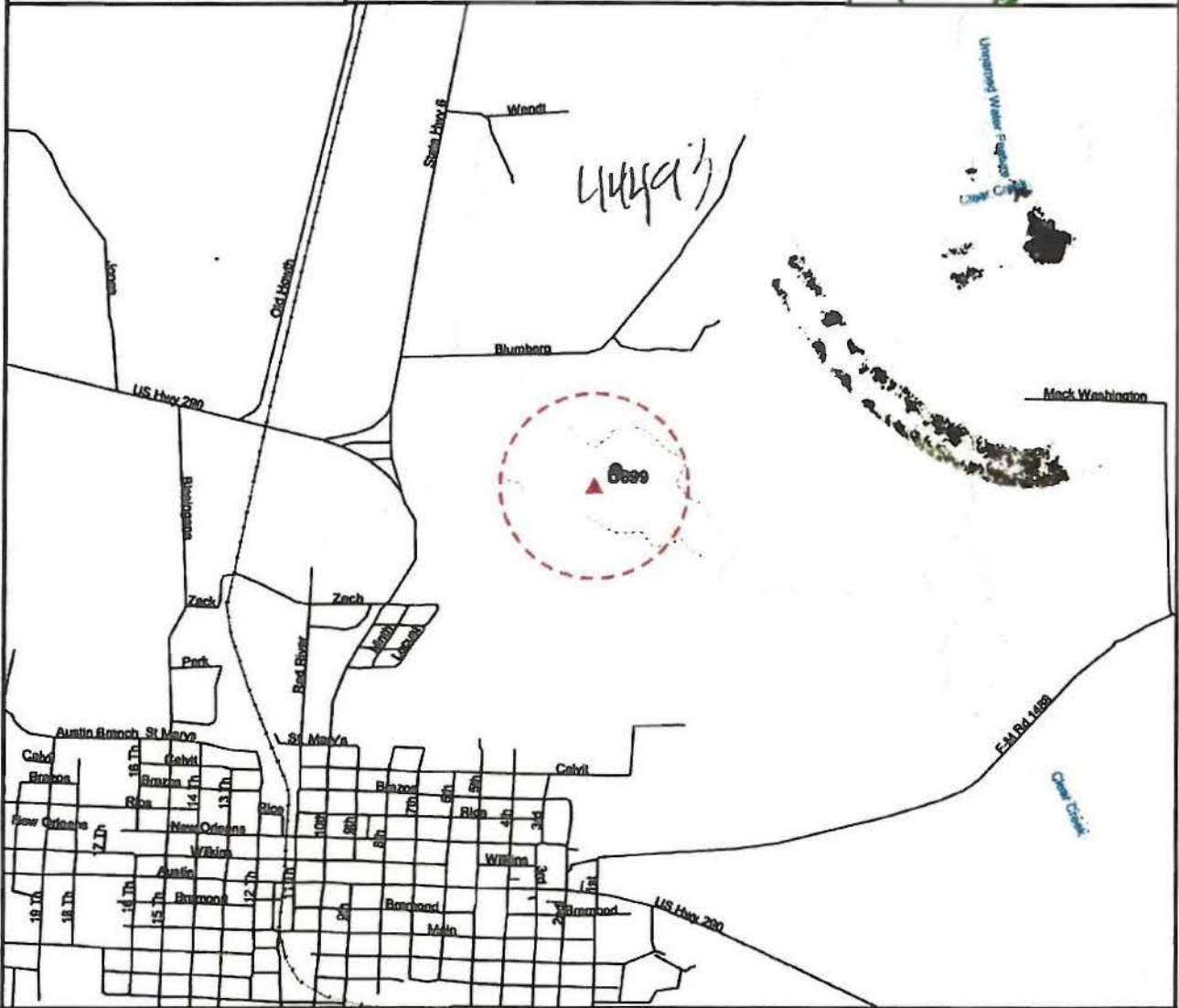
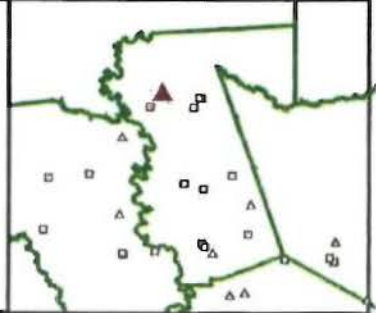

**Legend**

- Site U699
- 0.25 mile buffer around landfill boundary
- Roads
- Railroads
- Water features
- County boundary



**Original Coordinates**

Latitude N 30 6.78  
 Longitude W 96 4.09  
**GPS Coordinates from site visit**  
 Latitude N 30 6.82  
 Longitude W 96 4.04



Site ID: U699

County: Waller

Site Name: Hempstead

Location: N side of US 290 just E of SH 6

Key Map Page:

Classification:

Related Sites: No

**INFORMATION OBTAINED**

- |              |                                     |              |                          |                   |                                     |
|--------------|-------------------------------------|--------------|--------------------------|-------------------|-------------------------------------|
| TNRCC Files  | <input checked="" type="checkbox"/> | Landfill Map | <input type="checkbox"/> | Aerials           | <input checked="" type="checkbox"/> |
| Fire Ins Map | <input type="checkbox"/>            | Affidavit    | <input type="checkbox"/> | City Directory    | <input type="checkbox"/>            |
| Survey Map   | <input type="checkbox"/>            | Unit Map     | <input type="checkbox"/> | Health Dept Files | <input type="checkbox"/>            |
| Photos       | <input type="checkbox"/>            | Inspection   | <input type="checkbox"/> | Legal Description | <input type="checkbox"/>            |

Data Gap Actions: No exact acreage/boundary information (5 acres in TNRCC database).  
 No exact operation dates.  
 No landfill map, survey or metes & bounds.

**SITE INFORMATION**

Acreage:

Acreage Estimate: 1-5

Waste Types: Household waste

Research Suspended?

Date First Used:

Date Last Used:

**OWNER INFORMATION**

**Land Owners:**

Parcel Number A30110 A-11 Joseph Baker, Tract 15 (more)  
Owner Name: Machac, Milton & Carole Anne  
Address: P. O. Box 236, Waller, TX 77484 (Situs-Blumberg Road)

**On-Line Data Address:**

**Date Data Obtained:** 2/7/2001

**Land Use:**

Commercial (catfish farm)

**Adjacent Land Use:**

Vacant (woods), Transportation (Hwy 290)

**Observations:**

**Date Visited:**

11/30/2000

**BOUNDARY INFORMATION**

**Exact Boundaries Known?**

**Boundary Info Source:**

**Confidence Level:**

Unknown

**Boundary Description:**

**Special Notes:**

Identified in 1968 US Dept of HEW Survey

**Removal Notes:**



# Houston-Galveston Area Council Closed Landfill Inventory

**U1752**  
**WALLER County**  
 Prepared on 21 JUL 2003

**Disclaimer:**  
 This Closed or Abandoned Municipal Solid Waste Landfill Inventory was prepared from information furnished by the Texas Commission on Environmental Quality ("TCEQ"), permitting records on file with TCEQ and the Texas Department of Health, and from aerial photography and GIS data developed by the Houston-Galveston Area Council ("H-GAC"). The county map, individual site maps, and legal descriptions of the closed or abandoned municipal solid waste landfills represent TCEQ's and H-GAC's best judgment about the landfills' location, but neither TCEQ nor H-GAC warrants the accuracy, timeliness, or completeness of the maps or legal descriptions. Moreover, because TCEQ and H-GAC have inventoried only known municipal solid waste landfills, TCEQ and H-GAC make no representation about whether a specific tract of land may overlie an unknown municipal or other solid waste landfill.

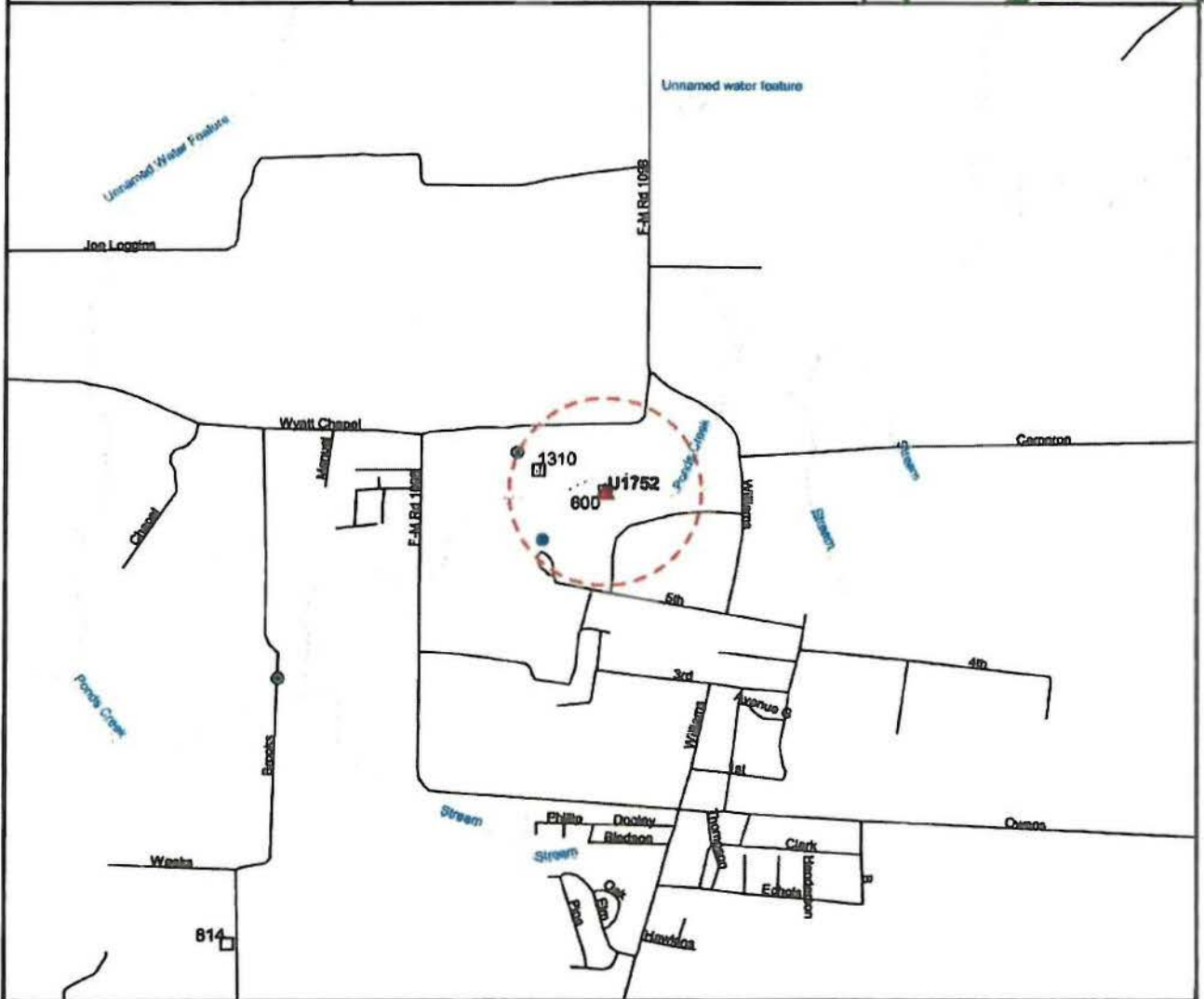
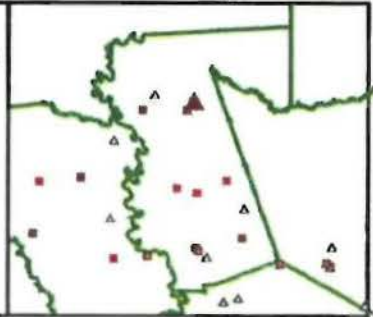

- Legend**
- 0.25 mile buffer around landfill boundary
  - Site U1752
  - GPS location from site visit
  - Other permitted sites
  - Other unpermitted sites
  - Roads
  - Water feature
  - County boundary

**H-GAC**  
 Houston-Galveston Area Council

**Wilbur Smith Associates**

**Original Coordinates**

Latitude N 30 6.00  
 Longitude W 95 59.50

**GPS Coordinates from site visit**

Latitude N NO DATA  
 Longitude W NO DATA







Site ID: U1752

County: Waller

Site Name: Prairie View A&M University

Location: N of and adjoining Prairie View A&M University campus

Key Map Page:

Classification:

Related Sites: 600

**INFORMATION OBTAINED**

TNRCC Files	<input checked="" type="checkbox"/>	Landfill Map	<input checked="" type="checkbox"/>	Aerials	<input checked="" type="checkbox"/>
Fire Ins Map	<input type="checkbox"/>	Affidavit	<input type="checkbox"/>	City Directory	<input type="checkbox"/>
Survey Map	<input checked="" type="checkbox"/>	Unit Map	<input type="checkbox"/>	Health Dept Files	<input type="checkbox"/>
Photos	<input checked="" type="checkbox"/>	Inspection	<input checked="" type="checkbox"/>	Legal Description	<input type="checkbox"/>

Data Gap Actions: No exact boundary information beyond general property map in file.  
 No exact operation dates.  
 Type of waste disposed unknown.  
 No detailed landfill map.

**SITE INFORMATION**

Acreage: 15

Acreage Estimate:

Waste Types:

Research Suspended?

Date First Used: 1/1/1959

Date Last Used: 1/1/1984

**OWNER INFORMATION**

**Land Owners:** Parcel Number A311100 J. Clary Tract 12, ac 436.7  
Owner Name: Prairie View A&M  
Address: PV A&M Univ., TX A&M Univ. System, 318 System Bldg., College Station, TX 77843

**On-Line Data Address:**

**Date Data Obtained:** 2/7/2001

**Land Use:** Public (treatment plant)

**Adjacent Land Use:** Institutional (college campus to the east and south), Vacant (woods to the west and north)

**Observations:** Property attendant indicated that Prairie View applied for a landfill permit, but the site never was a landfill. Outside the plant there is dumping along the edge of the woods.

**Date Visited:** 11/30/2000

**BOUNDARY INFORMATION**

**Exact Boundaries Known?**

**Boundary Info Source:** Affidavit and survey map

**Confidence Level:** Good Approximation

**Boundary Description:** Affidavit and survey map in file

**Special Notes:**

**Removal Notes:**

# Houston-Galveston Area Council Closed Landfill Inventory

**814**  
**WALLER County**  
 Prepared on 08 AUG 2003

**Disclaimer:**  
 This Closed or Abandoned Municipal Solid Waste Landfill inventory was prepared from information furnished by the Texas Commission on Environmental Quality ("TCEQ"), permitting records on file with TCEQ and the Texas Department of Health, and from aerial photography and GIS data developed by the Houston-Galveston Area Council ("H-GAC"). The county map, individual site maps, and legal descriptions of the closed or abandoned municipal solid waste landfills represent TCEQ's and H-GAC's best judgment about the landfills' location, but neither TCEQ nor H-GAC warrants the accuracy, timeliness, or completeness of the maps or legal descriptions. Moreover, because TCEQ and H-GAC have inventoried only known municipal solid waste landfills, TCEQ and H-GAC make no representation about whether a specific tract of land may overlie an unknown municipal or other solid waste landfill.

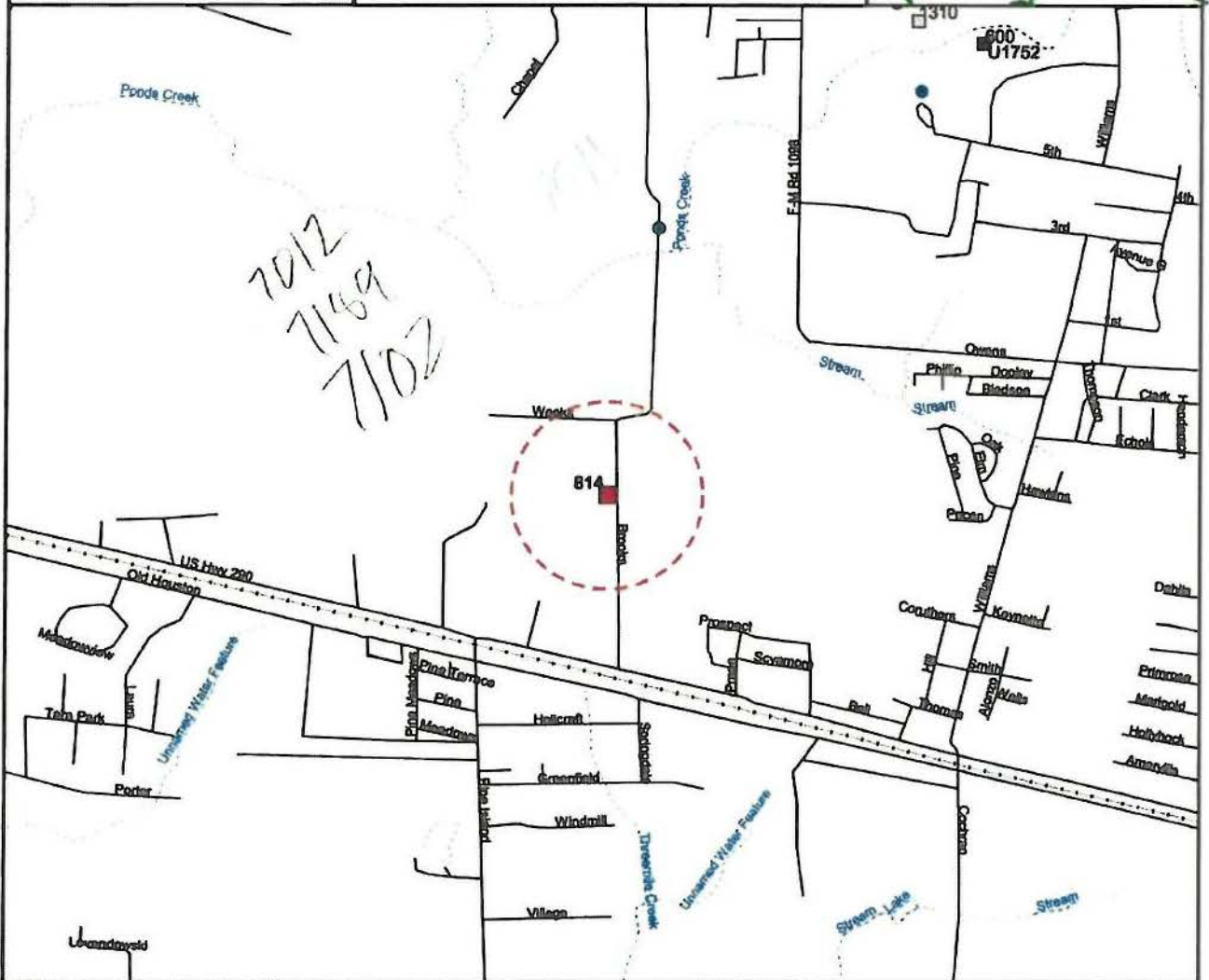
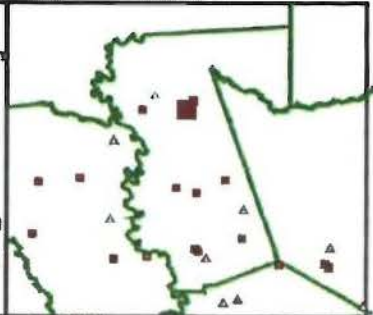

**Legend**

- Site 814
- ⋯ 0.25-mile buffer around landfill boundary
- GPS location from site visit
- Other permitted sites
- ▲ Other unpermitted sites
- Roads
- Railroads
- Water feature
- County boundary



**H-GAC**



ENGINEERS  
PLANNERS  
& ARCHITECTS

Wilbur Smith Associates

**Original Coordinates**



Latitude N 30 4.95

Longitude W 96 0.35

**GPS Coordinates from site visit**

Latitude N 30 5.57

Longitude W 96 0.24



Site ID: 814

County: Waller

Site Name: City of Waller

Location: 5 miles NW of Waller, 0.4 mile N of US 290 and W of Brooks Road in Prairie View

Key Map Page:

Classification: Municipal III

Related Sites: No

**INFORMATION OBTAINED**

- |              |                                     |              |                                     |                   |                                     |
|--------------|-------------------------------------|--------------|-------------------------------------|-------------------|-------------------------------------|
| TNRCC Files  | <input checked="" type="checkbox"/> | Landfill Map | <input checked="" type="checkbox"/> | Aerials           | <input type="checkbox"/>            |
| Fire Ins Map | <input type="checkbox"/>            | Affidavit    | <input checked="" type="checkbox"/> | City Directory    | <input type="checkbox"/>            |
| Survey Map   | <input type="checkbox"/>            | Unit Map     | <input checked="" type="checkbox"/> | Health Dept Files | <input type="checkbox"/>            |
| Photos       | <input type="checkbox"/>            | Inspection   | <input type="checkbox"/>            | Legal Description | <input checked="" type="checkbox"/> |

Data Gap Actions: General site map in file (including individual disposal units), but no detailed survey map.  
 No exact operation dates.  
 Type of waste disposed unknown.

**SITE INFORMATION**

Acreage: 4

Acreage Estimate:

Waste Types:

Research Suspended?

Date First Used: 1/1/1963

Date Last Used: 1/1/1985

## OWNER INFORMATION

**Land Owners:**

Parcel Number: A304100 A-41 Justo Liendo, Tr 152 Ac 60.32  
Owner Name: Gulf Western Mtg. Co.  
Address: PO Box 8333 Houston, TX 77004

Parcel Number: A304100 A-41 Justo Liendo, Tr 152-1 Ac 0.835  
Owner Name: YND Investments  
Address: P.O. Box 38591 Houston, TX 77004

Parcel Number: A904100 A-41 Justo Liendo Tr PT 109-1 ac 1  
Owner Name: Billy Don and Danita Russell  
Address: Route 4 Box 378-8H Hempstead, TX 77445

Parcel Number: A30400 A-41 Justo Liendo Tr 109-2 ac 13.34  
Owner Name: Jack and Diane Weeks, Sigifredo and Kathy Salmas  
Address: 4225 Bellis Dr. Houston, TX 77027-4401

Parcel Number: A304100 A-41 Justo Liendo, TR 109 ac 14  
Owner Name: Jack Weeks and Clint Bogart  
Address: 4225 Bellis Dr. Houston TX 77027

Parcel Number: A304100 A-41 Justo Liendo TR 109-1 4 ac P/o 5 ac  
Owner Name: Billy Don and Danita Russell  
Address: Route 4 Box 378-H Hempstead, TX 77445

**On-Line Data Address:** www.bxcountydata.com

**Date Data Obtained:** 8/5/2002

**Land Use:**

Vacant (woods)

**Adjacent Land Use:**

Vacant (woods), Transportation (Hwy 290)

**Observations:**

Site appears to be inaccessible due to dense woods and vegetation

**Date Visited:**

11/30/2000

## BOUNDARY INFORMATION

**Exact Boundaries Known?**

**Boundary Info Source:** Affidavit and landfill map

**Confidence Level:** Good Approximation

**Boundary Description:** Affidavit

**Special Notes:**

See file for property ownership information (six parcels included)

**Removal Notes:**



# Houston-Galveston Area Council Closed Landfill Inventory

**114**  
**WALLER County**  
 Prepared on 29 JUL 2003

**Disclaimer:**  
 This Closed or Abandoned Municipal Solid Waste Landfill Inventory was prepared from information furnished by the Texas Commission on Environmental Quality ("TCEQ"), permitting records on file with TCEQ and the Texas Department of Health, and from aerial photography and GIS data developed by the Houston-Galveston Area Council ("H-GAC"). The county map, individual site maps, and legal descriptions of the closed or abandoned municipal solid waste landfills represent TCEQ's and H-GAC's best judgment about the landfills' location, but neither TCEQ nor H-GAC warrants the accuracy, timeliness, or completeness of the maps or legal descriptions. Moreover, because TCEQ and H-GAC have inventoried only known municipal solid waste landfills, TCEQ and H-GAC make no representation about whether a specific tract of land may overlie an unknown municipal or other solid waste landfill.

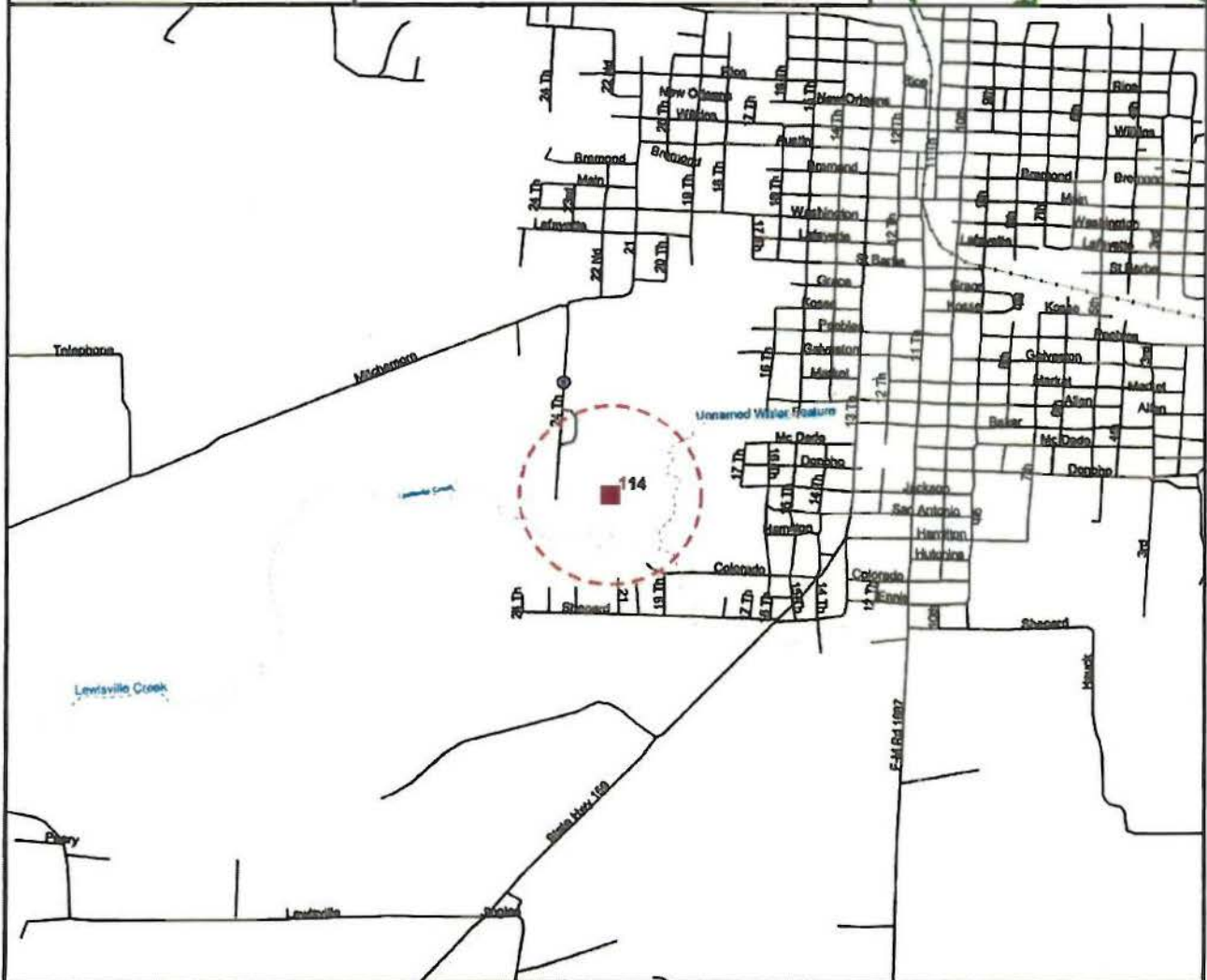
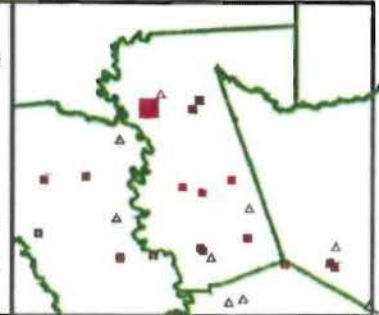

- Legend**
- 0.25-mile buffer around landfill boundary
  - Site 114
  - GPS location from site visit
  - Other permitted sites
  - Other unpermitted sites
  - Roads
  - Railroads
  - Water features
  - County boundary

<b>Original Coordinates</b>	
Latitude	N 30 5.00
Longitude	W 96 5.55
<b>GPS Coordinates from site visit</b>	
Latitude	N 30 5.28
Longitude	W 96 5.66



Site ID: 114

County: Waller

Site Name: City of Hempstead

Location: South end of 23rd Street within the City of Hempstead

Key Map Page:

Classification: Municipal II

Related Sites: No

**INFORMATION OBTAINED**

TNRCC Files	<input checked="" type="checkbox"/>	Landfill Map	<input checked="" type="checkbox"/>	Aerials	<input checked="" type="checkbox"/>
Fire Ins Map	<input type="checkbox"/>	Affidavit	<input checked="" type="checkbox"/>	City Directory	<input type="checkbox"/>
Survey Map	<input type="checkbox"/>	Unit Map	<input type="checkbox"/>	Health Dept Files	<input type="checkbox"/>
Photos	<input type="checkbox"/>	Inspection	<input type="checkbox"/>	Legal Description	<input checked="" type="checkbox"/>

Data Gap Actions: No exact operation dates.

**SITE INFORMATION**

Acreage: 27

Acreage Estimate:

Waste Types: Brush, household waste

Research Suspended?

Date First Used: 1/1/1976

Date Last Used: 1/1/1991

## **OWNER INFORMATION**

**Land Owners:**

Parcel Number Whole Block 519  
Owner Name: City of Hempstead  
Address: 1125 Austin St. Hempstead, TX 77445

Parcel Number Block 516 (All) Kit 1-10  
Owner Name: City of Hempstead  
Address: 1125 Austin St. Hempstead, TX 77445

Parcel Number Block 517(All) Lot 1-10  
Owner Name: City of Hempstead  
Address: 1125 Austin St. Hempstead, TX 77445

Parcel Number Block 569 (All) Lot 1-10  
Owner Name: City of Hempstead  
Address: 1125 Austin St. Hempstead, TX 77445

Parcel Number Block 570 (All) Lot 1-20  
Owner Name: City of Hempstead  
Address: 1125 Austin St. Hempstead, TX 77445

Parcel Number Block 571, Lot 6, 7, 8, 9, & 10  
Owner Name: City of Hempstead  
Address: 1125 Austin St. Hempstead, TX 77445

Parcel Number Block 595 (All) Lot 1-10  
Owner Name: City of Hempstead  
Address: 1125 Austin St. Hempstead, TX 77445

Parcel Number Block 598 (All) Lot 1-10  
Owner Name: City of Hempstead  
Address: 1125 Austin St. Hempstead, TX 77445

Parcel Number Block 597 Lot 6, 7, 8, 9, 10  
Owner Name: City of Hempstead  
Address: 1125 Austin St. Hempstead TX 77445

Parcel Number Block WB 543 Lot 1-10  
Owner Name: City of Hempstead  
Address: 1125 Austin St. Hempstead, TX 77445

Parcel Number Block WB 544, Lot 1-10  
Owner Name: City of Hempstead  
Address: 1125 Austin Co. Hempstead, TX 77445

Parcel Number Block WB 545  
Owner Name: City of Hempstead  
Address: 1125 Austin St. Hempstead, TX 77445

# Houston-Galveston Area Council Closed Landfill Inventory

**600**  
**WALLER County**  
 Prepared on 08 AUG 2003

**Disclaimer:**  
 This Closed or Abandoned Municipal Solid Waste Landfill Inventory was prepared from information furnished by the Texas Commission on Environmental Quality ("TCEQ"), permitting records on file with TCEQ and the Texas Department of Health, and from aerial photography and GIS data developed by the Houston-Galveston Area Council ("H-GAC"). The county map, individual site maps, and legal descriptions of the closed or abandoned municipal solid waste landfills represent TCEQ's and H-GAC's best judgment about the landfills' location, but neither TCEQ nor H-GAC warrants the accuracy, timeliness, or completeness of the maps or legal descriptions. Moreover, because TCEQ and H-GAC have inventoried only known municipal solid waste landfills, TCEQ and H-GAC make no representation about whether a specific tract of land may overlie an unknown municipal or other solid waste landfill.

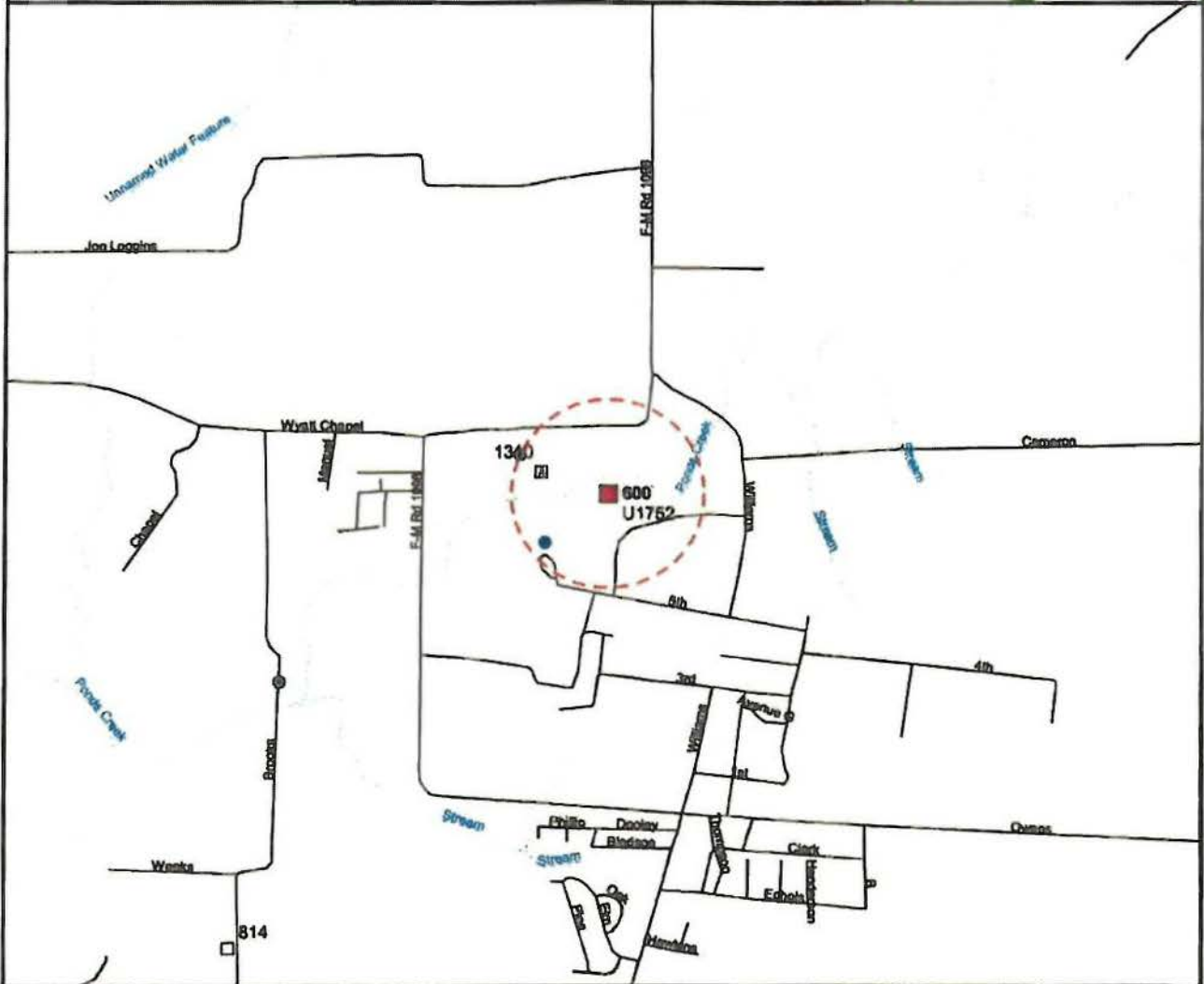
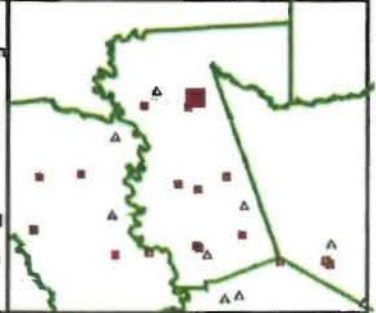

- Legend**
- Site 600
  - 0.25-mile buffer around landfill boundary
  - GPS location from site visit
  - Other permitted sites
  - △ Other unpermitted sites
  - Roads
  - ~ Water features
  - County boundary

**Original Coordinates**

Latitude	N 30 6.00
Longitude	W 95 59.50
<b>GPS Coordinates from site visit</b>	
Latitude	N 30 5.89
Longitude	W 95 59.84





Site ID: 600

County: Waller

Site Name: Prairie View A&M University

Location: N of and adjoining Prairie View A&M University campus

Key Map Page:

Classification: Municipal I & II

Related Sites: U1752

**INFORMATION OBTAINED**

TNRCC Files	<input checked="" type="checkbox"/>	Landfill Map	<input checked="" type="checkbox"/>	Aerials	<input checked="" type="checkbox"/>
Fire Ins Map	<input type="checkbox"/>	Affidavit	<input checked="" type="checkbox"/>	City Directory	<input type="checkbox"/>
Survey Map	<input checked="" type="checkbox"/>	Unit Map	<input type="checkbox"/>	Health Dept Files	<input type="checkbox"/>
Photos	<input checked="" type="checkbox"/>	Inspection	<input checked="" type="checkbox"/>	Legal Description	<input type="checkbox"/>

**Data Gap Actions:** No exact boundary information beyond general property map in file.  
 No exact operation dates.  
 Type of waste disposed unknown.  
 No detailed landfill map.

**SITE INFORMATION**

Acreage: 15

Acreage Estimate:

Waste Types:

Research Suspended?

Date First Used: 1/1/1959

Date Last Used: 1/1/1984

**OWNER INFORMATION**

**Land Owners:**

Parcel Number: A311100 J. Clary Tract 12, ac 436.7  
Owner Name: Prairie View A&M  
Address: PV A&M Univ., TX A&M Univ. System, 310 System Bldg., College Station, TX 77843

Parcel Number:  
Owner Name:  
Address:

**On-Line Data Address:**

**Date Data Obtained:** 8/5/2002

**Land Use:** Public (treatment plant)

**Adjacent Land Use:** Institutional (college campus to the east and south), Vacant (woods to the west and north)

**Observations:** Property attendant indicated that Prairie View applied for a landfill permit, but the site never was a landfill. Outside the plant there is dumping along the edge of the woods.

**Date Visited:** 11/30/2000

**BOUNDARY INFORMATION**

**Exact Boundaries Known?**

**Boundary Info Source:** Affidavit and survey map

**Confidence Level:** Good Approximation

**Boundary Description:** Affidavit and survey map in file

**Special Notes:**

**Removal Notes:**