



AECOM
303 E. Wacker Drive, Suite 1400
Chicago, Illinois 60601

312-373-7700 tel
312-373-6800 fax

August 6, 2014

Mr. Dan Martinez
Project Manager, Lakefront Trail Improvement
F.H. Paschen
5515 N. East River Road
Chicago, IL 60656

RE: Bi-weekly Letter Report Update #7
Lakefront Trail Improvement, Chicago, IL
AECOM Project No. 60318016

Dear Mr. Martinez:

Pursuant to conditions specified in permits issued by the City of Chicago, radiation monitoring was required to be performed for the above referenced project. AECOM Technical Services, Inc. (AECOM) provided the required radiation surveillance. The last update was issued on July 21, 2014 and summarized the surveying of excavation work performed between July 7 and 18, 2014. This update letter provides a summary of the radiological surveying performed between July 22 and August 1, 2014. The attached figure provides a brief summary of current and past radiological survey work.

Gamma radiation count measurements were made using Ludlum Model 2221 survey meter and an unshielded 2 x 2 inch NaI probe (Model 44-10). The U. S. Environmental Protection Agency (USEPA) cleanup value for Chicago's Streeterville area is 7.1 picocuries per gram (pCi/g) total radium (Ra-226 + Ra-228). The field instrument (Serial #172039) gamma count equivalent to 7.1 pCi/g was 19,598 counts per minute (cpm) unshielded.

New Sewer (Grand Avenue)

Between July 22 and August 1, 2014, excavation of a trench for the installation of a new sewer line was continued within Grand Avenue at Lake Shore Drive. For the instrument used, the gamma count threshold equivalent to the USEPA cleanup value of 7.1 pCi/g is 19,958 (cpm) unshielded. The field gamma background for the area is approximately 5,000 cpm unshielded. The field gamma measurements within the excavation and for the spoil materials generated during the excavation process did not exceed the instrument threshold previously stated. A range of gamma readings between 5,500 and 10,500 cpm unshielded were recorded during the excavation. Additional detail of the gamma counts and excavation locations is provided on the attached sketch. Thus, there was no indication of the presence of radiologically-contaminated material and/or an exceedance of the USEPA cleanup value of 7.1 pCi/g total radium.

Please contact us with any questions you have regarding this letter or the reported results.

Regards,

Steve T. Newlin
Senior Project Geologist

Steven C. Kornder, Ph.D.
Senior Project Geoscientist

cc: Chris Tryka, F.H. Paschen

Attachments: Location Map
ROW Sewer Sketch

LOCATION MAP

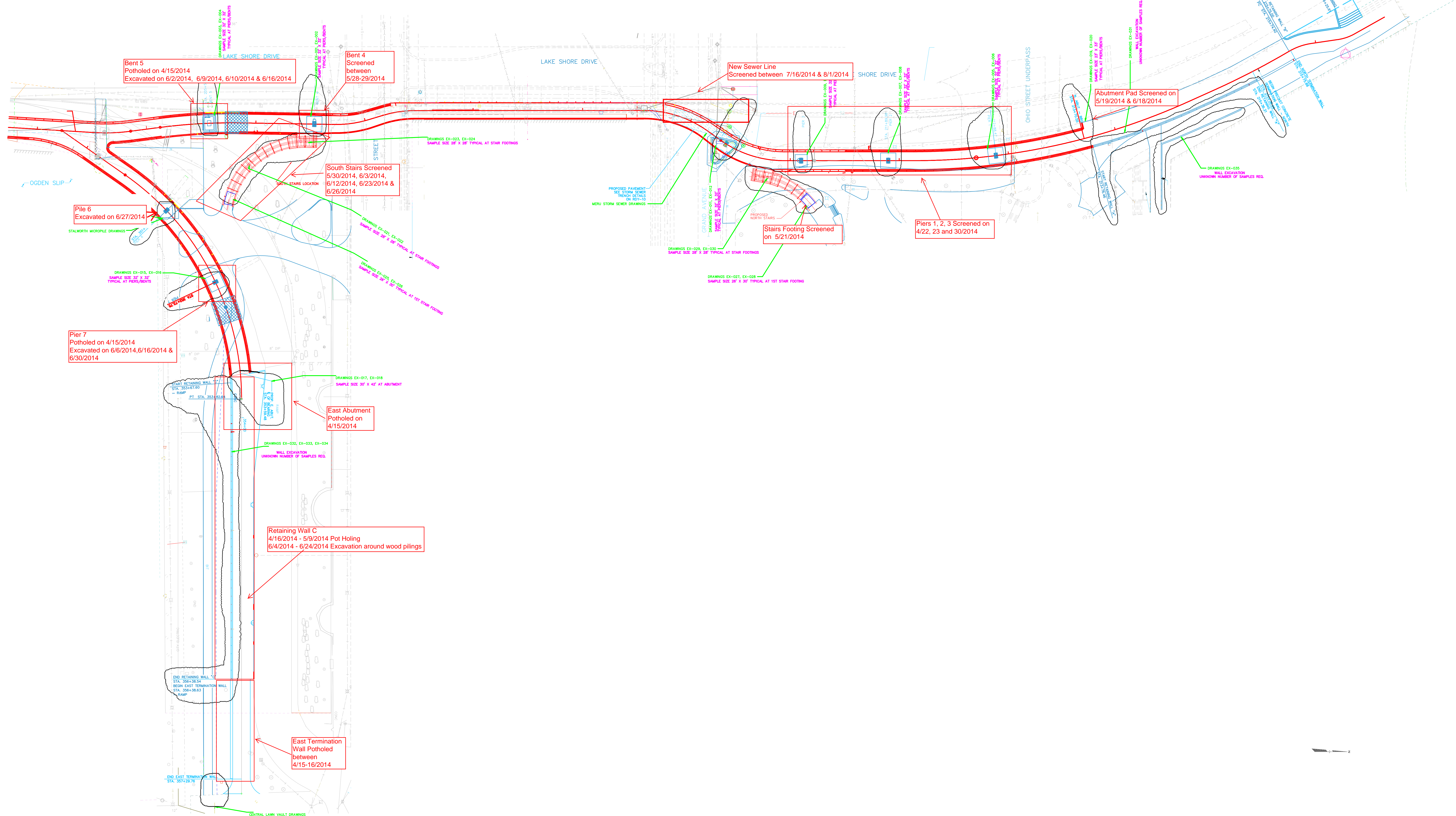

LAKEFRONT TRAIL IMPROVEMENT
FROM JANE ADDAMS PARK
TO OGDEN SLIP

OVERALL PROJECT PLAN
AECOM EXCAVATION PITS

REVISIONS			
NO.	BY	DATE	DESCRIPTION

	F.H. PASCHEN, S.N. NIELSEN & ASSOCIATES LLC GENERAL CONTRACTORS	
	DATE: 11/11/2013	SCALE: N.T.S.
DRAWING: G-001		

ROW SEWER SKETCH

SEWER INSTALLATION
ROW RADIOLOGICAL SOIL INVESTIGATION

NAVY PIER RELOADER PROJECT
7/22/2014 - 8/1/2014

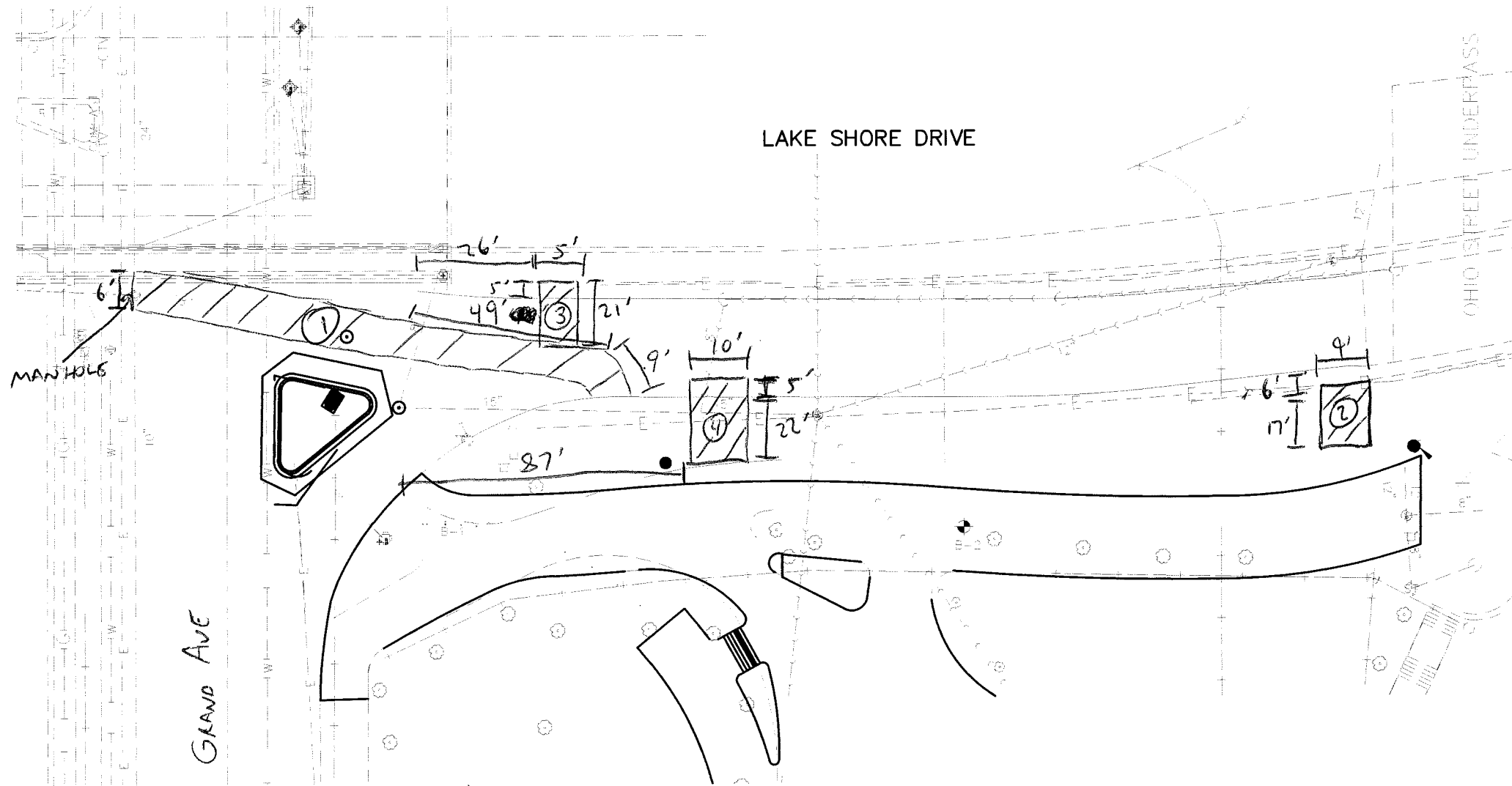

WOLUM-2221 w/ 2K2 NAI PROBE (UNSHIELDED)
S/N 176944

METER CUT-OFF: 17,930 cpm
(UNSHIELDED)

BACKGROUND - 5,000 cpm
(UNSHIELDED)

LOCATION	DEPTH	CPM
①	0-18"	CONCRETE
~6' bgs	18-36"	9400
	36-54"	8400
	54-72"	10500
	70-88"	7100

LOCATION	DEPTH	CPM
②	0-18"	7200
~8' bgs	18-36"	9900
	36-54"	9100
	54-72"	6700
	72-90"	6400
	90-108"	5600
	96-114"	6100

LOCATION	DEPTH	CPM
③	0-18"	CONCRETE
~5' bgs	18-36"	8900
	36-54"	9100
	54-72"	9300
	60-78"	7100

LOCATION	DEPTH	CPM
④	0-18"	6400
~5' bgs	18-36"	8700
	36-54"	6800
	54-72"	7500
	60-78"	7200