



999 Remington Boulevard, Suite A
Bolingbrook, Illinois 60440-3556
630.771.9200
Fax: 630.771.9250

February 5, 2007

Mr. Nate Nemani, P.E.
Environmental Engineer
USEPA Region 5
Waste, Pesticides and Toxics Division
77 West Jackson Boulevard (DW-8J)
Chicago, IL 60604-3590

**Subject: Transmittal
Analytical Results
PPG Oak Creek Facility
Oak Creek, Wisconsin
EPA ID# WID059972935
Wisconsin FID# 241014620**

Dear Mr. Nemani:

On behalf of PPG Industries (PPG), Shaw Environmental, Inc. (Shaw) is transmitting with this letter tabulated analytical results and ground water elevation maps generated as a result of two sampling events at the former tank farm area of the Oak Creek Wisconsin facility. Samples and ground water elevation information were collected on July 26, 2006 and November 16, 2006 in accordance with the July 9, 2004 letter to you and the October 19, 2006 Hydrogeologic Evaluation Work Plan (Plan). The November 16, 2006 sampling event represents the first event since deactivation of the underdrain system pursuant to the Plan.

Consistent with the Plan, the next sampling event will occur in February 2007. If you have questions about the analytical results or would like a copy of the results themselves please let me know.

Sincerely,

A handwritten signature in cursive script that reads "Will Starbuck" with the word "for" written below it in a smaller, simpler script.

Paul W. Lambert, CPG
Senior Project Manager

PWL/WS/bam

Enclosures

Mr. Nate Nemani, P.E.
USEPA Region 5
February 5, 2007
Page 2

cc: Walt Ebersol
Wisconsin Department of Natural Resources
Southeast Region
P.O. Box 12436
2300 Martin Luther King Boulevard
Milwaukee, WI 53212

Eric Amadi
Wisconsin Department of Natural Resources
P.O. Box 12436
2300 Martin Luther King Boulevard
Milwaukee, WI 53212

Mark Gordon (2 copies)
Wisconsin Department of Natural Resources
101 South Webster Street
P.O. Box 7921
Madison, WI 53707-7921

Brian McGuire
Environmental Remediation Project Manager
PPG Industries, Inc.
4325 Rosanna Drive
Allison Park, PA 15101

Tom Tersine
PPG Industries, Inc.
10800 South 18th Street
Oak Creek, WI 53154

**BTEX Analytical Results in Groundwater
May 2002 through November 2006
PPG Industries, Inc., Oak Creek, Wisconsin**

Well ID	Sample Date	Constituent (ug/L)			
		Benzene	Ethylbenzene	Toluene	Xylenes (Tot)
	MCL	5.0	700	1,000	10,000
LW-2	5/2/02	ND (0.4)	ND (5)	ND (5)	ND (5)
	7/26/04	ND (5)	ND (5)	ND (5)	ND (5)
	1/31/05	ND (5)	ND (5)	ND (5)	ND (5)
	7/5/05	ND (5)	ND (5)	ND (5)	ND (5)
	1/23/06	ND (0.4)	ND (5)	ND (5)	ND (5)
	7/26/06	ND (0.4)	0.4 J	ND (5)	2.2 J
	11/16/06	ND (0.4)	0.39 J	0.36 J	3.0 J
LW-6	5/1/02	ND (0.4)	0.44	ND (5)	0.74
	7/26/04	ND (5)	ND (5)	ND (5)	ND (5)
	1/31/05	ND (5)	ND (5)	ND (5)	ND (5)
	7/5/05	ND (5)	ND (5)	ND (5)	ND (5)
	1/23/06	ND (0.4)	ND (5)	ND (5)	ND (5)
	7/26/06	ND (0.4)	ND (5)	0.36 J	0.67 J
	11/16/06	ND (0.4)	0.5 J	ND (5)	0.84 J
LW-5	5/1/02	0.48	160	ND (5)	180
	7/26/04	0.49	99.7	ND (5)	6.27
	1/31/05	0.54	36.8	ND (5)	0.878
	7/5/05	0.314	13.8	ND (5)	1.52
	1/23/06	0.39	0.51	ND (5)	ND (5)
	7/26/06	0.39 J	1.9 J	0.33 J	1.1 J
	11/16/06	0.36 J	66	ND (5)	7.6
TF-1	5/1/02	0.5	0.82	ND (5)	1.2
	7/26/04	0.37	ND (5)	ND (5)	ND (5)
	1/31/05	ND (5)	ND (5)	ND (5)	ND (5)
	7/5/05	ND (5)	ND (5)	ND (5)	ND (5)
	1/23/06	ND (0.4)	ND (5)	ND (5)	ND (5)
	7/26/06	ND (0.4)	1.3 J	ND (5)	4.3 J
	11/16/06	3.8	39	3.0 J	16
TF-2	5/1/02	NS	NS	NS	NS
	7/26/04	0.876	647	ND (5)	2,160
	1/31/05	0.589	74	ND (5)	ND (5)
	7/5/05	0.805	1.45	ND (5)	ND (5)
	1/23/06	0.95	37	ND (5)	0.58
	7/26/06	0.61	44	ND (5)	95
	11/16/06	0.45	1,100	0.41 J	89
TF-3	5/1/02	2	190	280	1,300
	7/26/04	2.39	207	190	2,190
	1/31/05	4.62	178	256	3,890
	7/5/05	6.13	227	384	3,680
	1/23/06	1.6	99	32	570
	7/26/06	6.1	600	920	5,100
	11/16/06	7.3	1,200	290	5,500
MW-10	5/1/02	NS	NS	NS	NS
	7/26/04	NS	NS	NS	NS
	1/31/05	NS	NS	NS	NS
	7/5/05	NS	NS	NS	NS
	1/23/06	NS	NS	NS	NS
	7/26/06	ND (0.4)	ND (5)	ND (5)	0.64 J
	11/16/06	ND (0.4)	ND (5)	ND (5)	ND (5)
MW-11	5/1/02	ND (0.4)	ND (5)	ND (5)	ND (5)
	7/26/04	ND (5)	ND (5)	ND (5)	ND (5)
	1/31/05	ND (5)	ND (5)	ND (5)	ND (5)
	7/5/05	ND (5)	ND (5)	ND (5)	ND (5)
	1/23/06	ND (0.4)	ND (5)	ND (5)	ND (5)
	7/26/06	ND (0.4)	ND (5)	ND (5)	ND (5)
	11/16/06	ND (0.4)	ND (5)	ND (5)	ND (5)
MW-12	5/1/02	ND (0.4)	ND (5)	ND (5)	ND (5)
	7/26/04	ND (5)	ND (5)	ND (5)	ND (5)
	1/31/05	ND (5)	ND (5)	ND (5)	ND (5)
	7/5/05	ND (5)	ND (5)	ND (5)	ND (5)
	1/23/06	ND (0.4)	ND (5)	ND (5)	ND (5)
	7/26/06	ND (0.4)	ND (5)	ND (5)	ND (5)
	11/16/06	ND (0.4)	ND (5)	ND (5)	ND (5)

MCL = Maximum Contaminant Level

ND (5) = Not detected at the detection Limit in parenthesis.

NS = Not sampled

OFFICE: Pittsburgh, PA
 DRAWN BY: B. Faison
 CHECKED BY: W. Starnhope
 APPROVED BY:
 DRAWING NUMBER: 119637-B5

Image: .
 Xref: .
 O:\Project\PPG\119637\119637B5.dwg
 Plot Date/Time: 01/25/07 04:09pm
 Plotted by: bernadette.oconnor

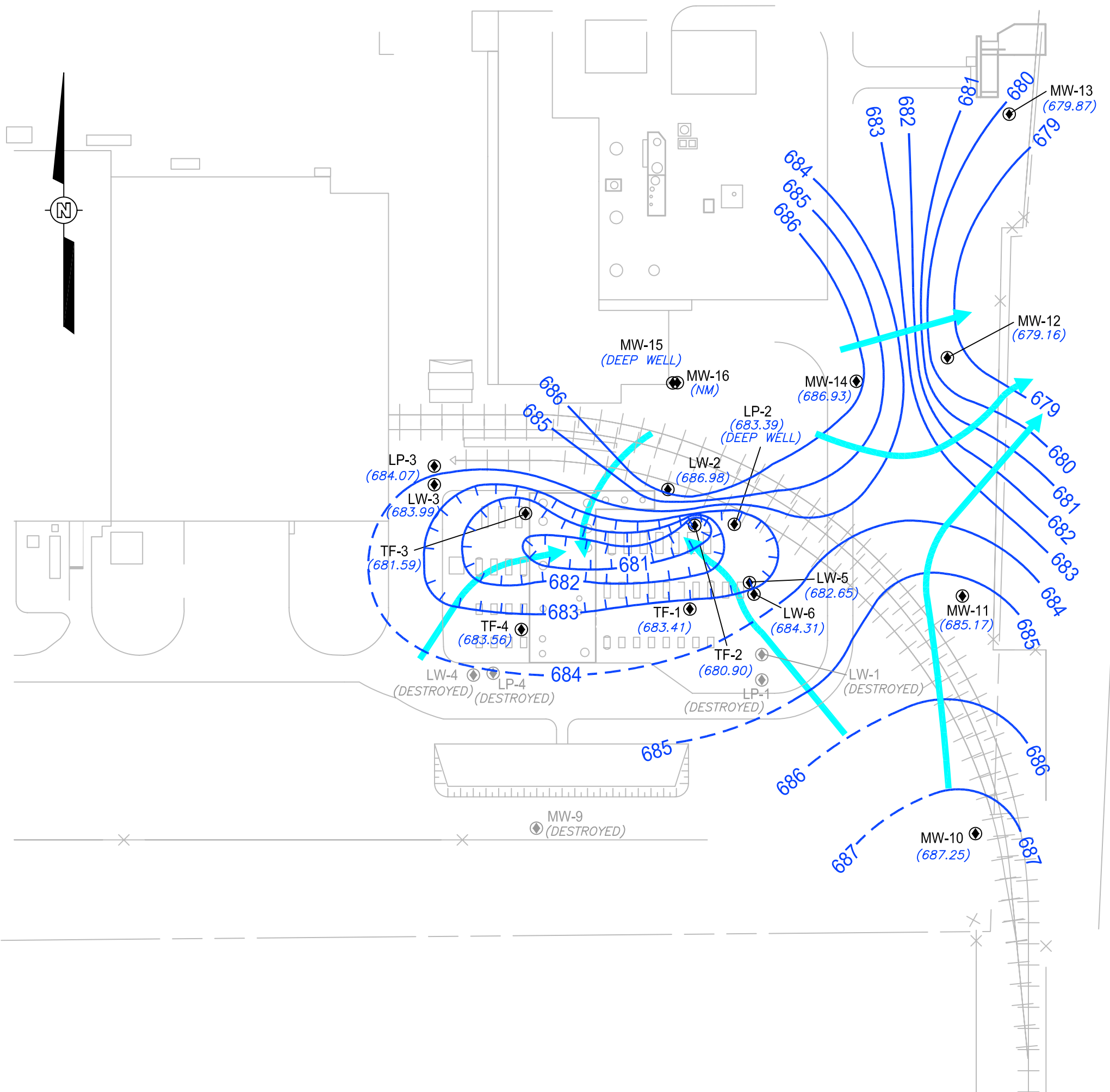

LEGEND:

- MONITORING WELL LOCATIONS
- GROUNDWATER ELEVATION (MSL)
- NOT MEASURED
- GROUNDWATER CONTOUR (DASHED WHERE INFERRED)
- DIRECTION OF GROUNDWATER FLOW

NOTES:

1. WATER ELEVATIONS WERE GAUGED AT SOME DEEP WELLS BUT THE GROUND-WATER ELEVATIONS ARE NOT PROVIDED ON THE MAP BECAUSE THESE DATA ARE NOT USED FOR CONTOURING.
2. BASED ON WATER LEVELS MEASURED JULY 26, 2006.



PPG INDUSTRIES, INC.
 OAK CREEK, WISCONSIN



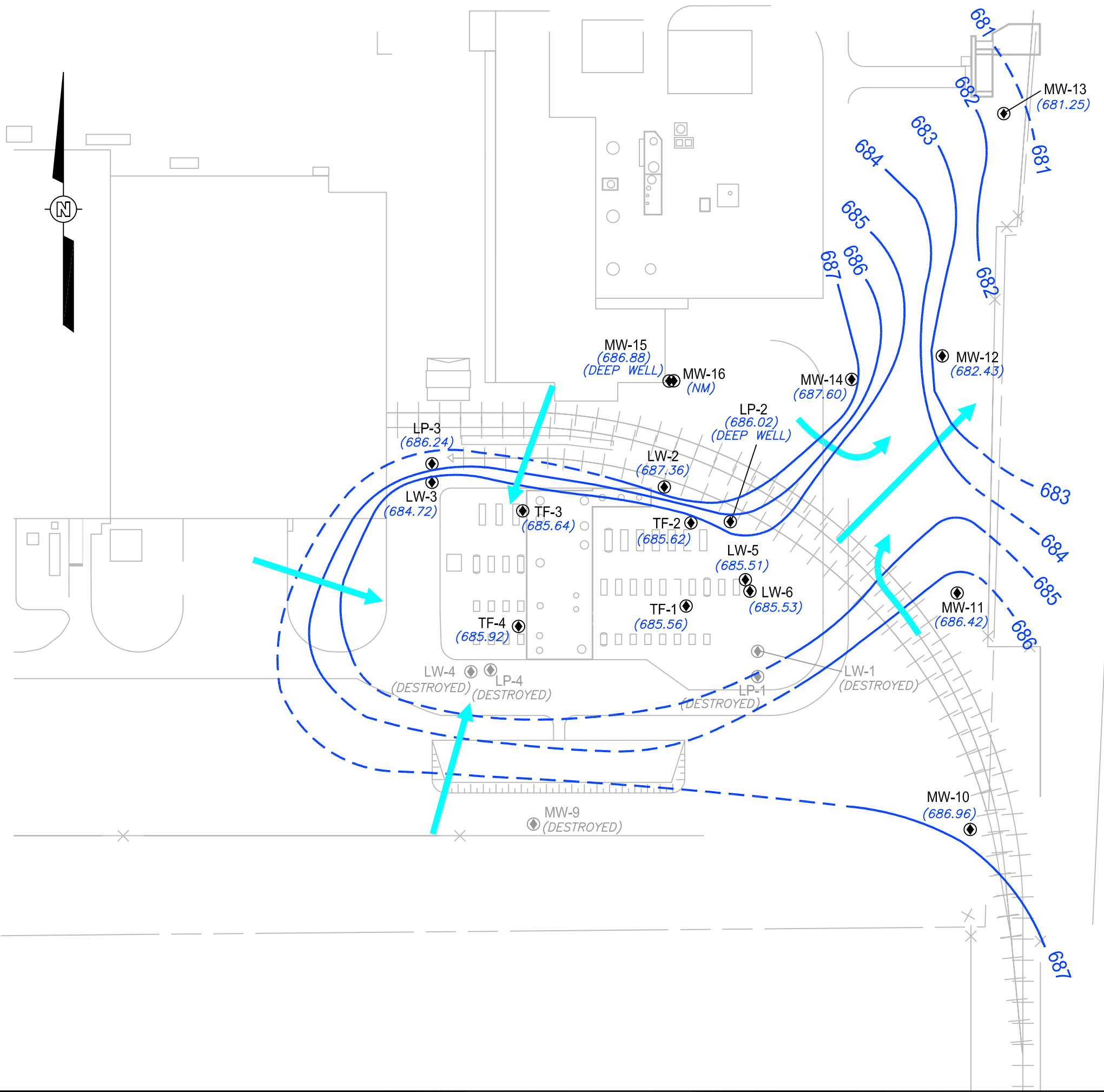

FIGURE 1
 GROUNDWATER ELEVATION MAP
 JULY 26, 2006
 HYDROGEOLOGIC EVALUATION
 OAK CREEK, WISCONSIN

OFFICE: Pittsburgh, PA
 DRAWN BY: B. Faison
 CHECKED BY: W. Starnhope
 APPROVED BY:
 DRAWING NUMBER: 119637-B6

Image: 0897_001
 Plot Date/Time: 01/25/07 04:47pm
 Plotted by: bernadette.oconnor



LEGEND:

-  MONITORING WELL LOCATIONS
-  (683.35) GROUNDWATER ELEVATION (MSL)
-  (NM) NOT MEASURED
-  GROUNDWATER CONTOUR (DASHED WHERE INFERRED)
-  DIRECTION OF GROUNDWATER FLOW

- NOTES:**
1. WATER ELEVATIONS WERE GAUGED AT SOME DEEP WELLS BUT THE GROUND-WATER ELEVATIONS ARE NOT PROVIDED ON THE MAP BECAUSE THESE DATA ARE NOT USED FOR CONTOURING.
 2. BASED ON WATER LEVELS MEASURED NOVEMBER 16, 2006.
 3. DEEP WELLS (MW-15 AND LP-2) NOT USED FOR CONTOURING PURPOSES.



PPG INDUSTRIES, INC.
OAK CREEK, WISCONSIN

FIGURE 2
 GROUNDWATER ELEVATION MAP
 NOVEMBER 16, 2006
 HYDROGEOLOGIC EVALUATION
 OAK CREEK, WISCONSIN