

December 7, 2010

Mr. Nate Nemani, P.E.
Environmental Engineer
USEPA Region 5 - Waste, Pesticides and Toxics Division
77 West Jackson Boulevard (DW-8J)
Chicago, IL 60604-3590

Subject: **Transmittal - Analytical Results and Summary of Product Removal at TF-3
PPG Oak Creek Facility
Oak Creek, Wisconsin
EPA ID# WID059972935
Wisconsin FID# 241014620**

Dear Mr. Nemani:

On behalf of PPG Industries, Inc. (PPG), Shaw Environmental, Inc. is transmitting with this letter the tabulated analytical results and the groundwater elevation map generated as a result of the September 2010 sampling event at the former tank farm area of the Oak Creek Wisconsin facility. Samples and groundwater elevation information were collected on September 14, 2010 in accordance with the July 9, 2004 letter to you and the October 19, 2006 Hydrogeologic Evaluation Work Plan (Plan).

PPG began free product removal from Monitoring Well TF-3 on March 13, 2009. A summary table that provides the date, thickness of free product, and the total volume of liquid removed from the well is provided. Please note that when the groundwater level was measured at Monitoring Well TF-3 during this sampling event (September 14, 2010), only a small amount of free product was observed above the groundwater table (approximately one quarter inch); therefore, a groundwater sample was collected.

During the March 2010 sampling event, it was noted that monitoring well MW-11 was damaged during snow removal. The damage did not allow for collection of a sample at this well in March. During the September monitoring event Shaw repaired the well casing and established a new top of casing (TOC) elevation. A groundwater sample was collected and water levels were measured using the new TOC measurement.

If you have questions regarding this submittal, please let me know.

Sincerely,



William Stanhope
Project Manager

WS/bam
Enclosures

Mr. Nate Nemani, P.E.
USEPA Region 5
December 7, 2010
Page 2

cc: Walt Ebersol
Wisconsin Department of Natural Resources
Southeast Region
P.O. Box 12436
2300 Martin Luther King Boulevard
Milwaukee, WI 53212

Eric Amadi
Wisconsin Department of Natural Resources
P.O. Box 12436
2300 Martin Luther King Boulevard
Milwaukee, WI 53212

Mark Gordon (2 copies)
Wisconsin Department of Natural Resources
101 South Webster Street
P.O. Box 7921
Madison, WI 53707-7921

Brian McGuire
Environmental Remediation Project Manager
PPG Industries, Inc.
4325 Rosanna Drive
Allison Park, PA 15101

Tom Tersine
PPG Industries, Inc.
10800 South 18th Street
Oak Creek, WI 531541

BTEX Analytical Results in Groundwater
May 2002 through September 2010
PPG Industries, Inc., Oak Creek, Wisconsin

Well ID	Sample Date	Constituent (ug/L)			
		Benzene 5.0	Ethylbenzene 700	Toluene 1,000	Xylenes (Total) 10,000
	MCL				
LW-2	5/2/02	ND (0.4)	ND (5)	ND (5)	ND (5)
	7/26/04	ND (5)	ND (5)	ND (5)	ND (5)
	1/31/05	ND (5)	ND (5)	ND (5)	ND (5)
	7/5/05	ND (5)	ND (5)	ND (5)	ND (5)
	1/23/06	ND (0.4)	ND (5)	ND (5)	ND (5)
	7/26/06	ND (0.4)	0.4 J	ND (5)	2.2 J
	11/16/06	ND (0.4)	0.39 J	0.36 J	3.0 J
	2/21/07	ND (0.4)	ND (5)	ND (5)	ND (5)
	7/18/07	ND (0.4)	ND (5)	ND (5)	ND (5)
	9/25/07	ND (0.4)	ND (5)	ND (5)	ND (5)
	12/13/07	ND (0.4)	0.33 J	ND (5)	1.3 J
	3/27/08	ND (0.4)	ND (5)	0.78 J	ND (5)
	6/26/08	ND (0.4)	ND (5)	ND (5)	ND (5)
	9/24/08	ND (0.4)	ND (5)	ND (5)	ND (5)
	3/27/09	ND (0.4)	ND (5)	ND (5)	ND (5)
9/23/09	ND (0.4)	ND (5)	ND (5)	ND (5)	
3/10/10	ND (0.4)	ND (5)	ND (5)	ND (5)	
9/14/10	ND (0.4)	ND (5)	ND (5)	ND (5)	
LW-6	5/1/02	ND (0.4)	0.44	ND (5)	0.74
	7/26/04	ND (5)	ND (5)	ND (5)	ND (5)
	1/31/05	ND (5)	ND (5)	ND (5)	ND (5)
	7/5/05	ND (5)	ND (5)	ND (5)	ND (5)
	1/23/06	ND (0.4)	ND (5)	ND (5)	ND (5)
	7/26/06	ND (0.4)	ND (5)	0.36 J	0.67 J
	11/16/06	ND (0.4)	0.5 J	ND (5)	0.84 J
	2/21/07	ND (0.4)	ND (5)	ND (5)	ND (5)
	7/18/07	ND (0.4)	ND (5)	ND (5)	ND (5)
	9/25/07	ND (0.4)	0.31 J	ND (5)	0.65 J
	12/13/07	ND (0.4)	ND (5)	0.33 J	0.51 J
	3/27/08	ND (0.4)	ND (5)	ND (5)	0.66 J
	6/26/08	ND (0.4)	ND (5)	ND (5)	ND (5)
	9/24/08	ND (0.4)	ND (5)	ND (5)	ND (5)
	3/27/09	ND (0.4)	ND (5)	ND (5)	0.59 J
9/23/09	ND (0.4)	0.38J	ND (5)	0.81J	
3/10/10	ND (0.4)	ND (5)	ND (5)	ND (5)	
9/14/10	ND (0.4)	ND (5)	ND (5)	ND (5)	
LW-5	5/1/02	0.48	160	ND (5)	180
	7/26/04	0.49	99.7	ND (5)	6.27
	1/31/05	0.54	36.8	ND (5)	0.878
	7/5/05	0.314	13.8	ND (5)	1.52
	1/23/06	0.39	0.51	ND (5)	ND (5)
	7/26/06	0.39 J	1.9 J	0.33 J	1.1 J
	11/16/06	0.36 J	66	ND (5)	7.6
	2/21/07	0.23 J	120	ND (5)	5.7
	7/18/07	0.13 J	5.3	ND (5)	2.0 J
	9/25/07	0.26 J	3.4 J	ND (5)	0.87 J
	12/13/07	0.23 J	2.1 J	0.29 J	0.91 J
	3/27/08	ND (0.4)	0.27 J	0.47 J	0.89 J
	6/26/08	ND (0.4)	1.1 J	ND (5)	ND (5)
	9/24/08	ND (0.4)	0.4J	ND (5)	ND (5)
	3/27/09	0.15 J	0.31 J	ND (5)	0.80 J
9/23/09	0.13J	ND (5)	ND (5)	ND (5)	
3/10/10	ND (0.4)	ND (5)	ND (5)	ND (5)	
9/14/10	0.3 J	0.91 J	ND (5)	ND (5)	

**BTEX Analytical Results in Groundwater
May 2002 through September 2010
PPG Industries, Inc., Oak Creek, Wisconsin**

Well ID	Sample Date	Constituent (ug/L)			
		Benzene 5.0	Ethylbenzene 700	Toluene 1,000	Xylenes (Total) 10,000
MCL					
TF-1	5/1/02	0.5	0.82	ND (5)	1.2
	7/26/04	0.37	ND (5)	ND (5)	ND (5)
	1/31/05	ND (5)	ND (5)	ND (5)	ND (5)
	7/5/05	ND (5)	ND (5)	ND (5)	ND (5)
	1/23/06	ND (0.4)	ND (5)	ND (5)	ND (5)
	7/26/06	ND (0.4)	1.3 J	ND (5)	4.3 J
	11/16/06	3.8	39	3.0 J	16
	2/21/07	5.9	750	0.85 J	58
	7/18/07	2.4	220	6.7 J	110
	9/25/07	0.9	23	0.56 J	9.5
	12/13/07	2.1	180	0.91 J	120
	3/27/08	2.3	95	1.1 J	53
	6/26/08	1.6	6.3	0.99 J	10
	9/24/08	1.8	1.7 J	ND (5)	3.6 J
	3/27/09	3.1	9.3	0.7 J	11
9/23/09	3	5.9	1.9 J	17	
3/10/10	5.5	29	1.1 J	19	
9/14/10	3.4	0.75 J	ND (5)	ND (5)	
TF-2	5/1/02	NS	NS	NS	NS
	7/26/04	0.876	647	ND (5)	2,160
	1/31/05	0.589	74	ND (5)	ND (5)
	7/5/05	0.805	1.45	ND (5)	ND (5)
	1/23/06	0.95	37	ND (5)	0.58
	7/26/06	0.61	44	ND (5)	95
	11/16/06	0.45	1,100	0.41 J	89
	2/21/07	ND (2)	340	ND (25)	700
	7/18/07	ND (2)	350	ND (25)	2,700
	9/25/07	ND (4)	88	ND (50)	1,100
	12/13/07	0.81	79	0.5 J	210
	3/27/08	2.1	880	5.2	2,600
	6/26/08	2.2	500 J	2.9 J	3,900
	9/24/08	1.9 J	300	ND (50)	1,700
	3/27/09	4.7	800	3.0 J	3,400
9/23/09	5.5	170	1.0 J	250	
3/10/10	2.9	85	ND (5)	200	
9/14/10	0.8	30	0.34 J	120	
TF-3	5/1/02	2	190	280	1,300
	7/26/04	2.39	207	190	2,190
	1/31/05	4.62	178	256	3,890
	7/5/05	6.130	227	384	3,680
	1/23/06	1.60	99	32	570
	7/26/06	6.10	600	920	5,100
	11/16/06	7.3	1,200	290	5,500
	2/21/07	27	1,900	1,500	11,000
	7/18/07	51	4,100	9,000	45,000
	9/25/07	57 J	3,400	5,100	28,000
	12/13/07	38 J	2,800	1,900	15,000
	3/27/08	45 J	3,400	6,800	32,000
	6/26/08	88	6,300	15,000	78,000
	9/24/08	FREE PRODUCT IN MONITORING WELL			
	3/27/09	FREE PRODUCT IN MONITORING WELL			
9/23/09	SAMPLE NOT COLLECTED				
3/10/10	ND (200)	2,300 J	4,200	21,000	
9/14/10	26 J	2,200	2,400	15,000	

BTEX Analytical Results in Groundwater
May 2002 through September 2010
PPG Industries, Inc., Oak Creek, Wisconsin

Well ID	Sample Date	Constituent (ug/L)			
		Benzene 5.0	Ethylbenzene 700	Toluene 1,000	Xylenes (Total) 10,000
MCL					
MW-10	5/1/02	NS	NS	NS	NS
	7/26/04	NS	NS	NS	NS
	1/31/05	NS	NS	NS	NS
	7/5/05	NS	NS	NS	NS
	1/23/06	NS	NS	NS	NS
	7/26/06	ND (0.4)	ND (5)	ND (5)	0.64 J
	11/16/06	ND (0.4)	ND (5)	ND (5)	ND (5)
	2/21/07	ND (0.4)	ND (5)	ND (5)	ND (5)
	7/18/07	ND (0.4)	ND (5)	ND (5)	ND (5)
	9/25/07	ND (0.4)	ND (5)	ND (5)	ND (5)
	12/13/07	ND (0.4)	ND (5)	0.65 J	3.9 J
	3/27/08	ND (0.4)	ND (5)	ND (5)	ND (5)
	6/26/08	ND (0.4)	ND (5)	0.83 J	ND (5)
	9/24/08	ND (0.4)	ND (5)	ND (5)	ND (5)
	3/27/09 (1)	160	1.6 J	15	3.0 J
	4/30/09	0.18 J	ND (5)	ND (5)	ND (5)
	9/23/09	ND (0.4)	ND (5)	ND (5)	ND (5)
3/10/10	ND (0.4)	ND (5)	ND (5)	ND (5)	
9/14/10	ND (0.4)	ND (5)	ND (5)	ND (5)	
MW-11	5/1/02	ND (0.4)	ND (5)	ND (5)	ND (5)
	7/26/04	ND (5)	ND (5)	ND (5)	ND (5)
	1/31/05	ND (5)	ND (5)	ND (5)	ND (5)
	7/5/05	ND (5)	ND (5)	ND (5)	ND (5)
	1/23/06	ND (0.4)	ND (5)	ND (5)	ND (5)
	7/26/06	ND (0.4)	ND (5)	ND (5)	ND (5)
	11/16/06	ND (0.4)	ND (5)	ND (5)	ND (5)
	2/21/07	ND (0.4)	ND (5)	ND (5)	ND (5)
	7/18/07	ND (0.4)	ND (5)	ND (5)	ND (5)
	9/25/07	ND (0.4)	ND (5)	ND (5)	ND (5)
	12/13/07	ND (0.4)	ND (5)	ND (5)	ND (5)
	3/27/08	ND (0.4)	ND (5)	0.67 J	ND (5)
	6/26/08	ND (0.4)	ND (5)	ND (5)	ND (5)
	9/24/08	ND (0.4)	ND (5)	ND (5)	ND (5)
	3/27/09 (1)	0.4	ND (5)	ND (5)	ND (5)
	4/30/09	ND (0.4)	ND (5)	ND (5)	ND (5)
	9/23/09	ND (0.4)	ND (5)	ND (5)	ND (5)
3/10/10	WELL DAMAGED - SAMPLE NOT COLLECTED				
9/14/10	ND (0.4)	ND (5)	ND (5)	ND (5)	

BTEX Analytical Results in Groundwater
May 2002 through September 2010
PPG Industries, Inc., Oak Creek, Wisconsin

Well ID	Sample Date	Constituent (ug/L)			
		Benzene 5.0	Ethylbenzene 700	Toluene 1,000	Xylenes (Total) 10,000
MCL					
MW-12	5/1/02	ND (0.4)	ND (5)	ND (5)	ND (5)
	7/26/04	ND (5)	ND (5)	ND (5)	ND (5)
	1/31/05	ND (5)	ND (5)	ND (5)	ND (5)
	7/5/05	ND (5)	ND (5)	ND (5)	ND (5)
	1/23/06	ND (0.4)	ND (5)	ND (5)	ND (5)
	7/26/06	ND (0.4)	ND (5)	ND (5)	ND (5)
	11/16/06	ND (0.4)	ND (5)	ND (5)	ND (5)
	2/21/07	ND (0.4)	ND (5)	ND (5)	ND (5)
	7/18/07	ND (0.4)	ND (5)	ND (5)	ND (5)
	9/25/07	ND (0.4)	ND (5)	ND (5)	ND (5)
	12/13/07	ND (0.4)	ND (5)	0.26 J	0.84 J
	3/27/08	ND (0.4)	ND (5)	0.57 J	ND (5)
	6/26/08	ND (0.4)	ND (5)	ND (5)	ND (5)
	9/24/08	ND (0.4)	ND (5)	ND (5)	ND (5)
	3/27/09 (1)	0.23 J	ND (5)	ND (5)	ND (5)
	4/30/09	ND (0.4)	ND (5)	ND (5)	ND (5)
	9/23/09	ND (0.4)	ND (5)	ND (5)	ND (5)
3/10/10	ND (0.4)	ND (5)	ND (5)	ND (5)	
9/14/10	ND (0.4)	ND (5)	ND (5)	ND (5)	
MW-14	7/18/07	ND (0.4)	ND (5)	ND (5)	ND (5)
	9/25/07	ND (0.4)	ND (5)	ND (5)	ND (5)
	12/13/07	ND (0.4)	ND (5)	ND (5)	ND (5)
	3/27/08	ND (0.4)	ND (5)	0.61 J	ND (5)
	6/26/08	ND (0.4)	ND (5)	0.80 J	ND (5)
	9/24/08	ND (0.4)	ND (5)	ND (5)	ND (5)
	3/27/09 (1)	0.29 J	ND (5)	ND (5)	ND (5)
	4/30/09	2.1	ND (5)	ND (5)	ND (5)
	9/23/09	ND (0.4)	ND (5)	ND (5)	ND (5)
	3/10/10	ND (0.4)	ND (5)	ND (5)	ND (5)
	9/14/10	ND (0.4)	ND (5)	ND (5)	ND (5)
Notes:					
Concentrations are in micrograms per liter (ug/L)					
MCL = Maximum Contaminant Level					
ND (5) = Not detected at the detection limit in parentheses					
NS = Not sampled					
(1) March 2009 samples were re-sampled in April 2009.					

Groundwater Elevations July 2004 through September 2010
Based on January 2006 Re-Survey
PPG Industries, Inc., Oak Creek, Wisconsin

Monitoring Well ID	Ground Elevation (msl)	TOC Elevation* (msl)	July 2004		January 2005		July 2005		January 2006	
			Depth to Water (TOC)	Ground-water Elevation	Depth to Water (TOC)	Ground-water Elevation	Depth to Water (TOC)	Ground-water Elevation	Depth to Water (TOC)	Ground-water Elevation
LP-2**	696.83	697.79	NM	---	NM	---	NM	---	14.55	683.24
LP-3	695.84	696.18	NM	---	NM	---	NM	---	12.77	683.41
LW-2	697.34	698.62	12.75	685.87	13.76	684.86	14.33	684.29	12.87	685.75
LW-3	695.76	696.39	NM	---	NM	---	NM	---	12.7	683.69
LW-5	695.79	698.40	15.54	682.86	15.49	682.91	15.62	682.78	15.75	682.65
LW-6	695.61	698.19	14.06	684.13	14.49	683.7	14.13	684.06	14.26	683.93
MW-10	693.18	696.43	Well Damaged; Not Measured							
MW-11	689.20	692.20	6.47	685.13	6.87	684.73	8.0	683.6	5.4	686.2
MW-12	685.60	687.92	7.03	680.89	6.41	681.51	9.74	678.18	5.44	682.48
MW-13	683.80	686.35	NM	---	NM	---	NM	---	NM	---
MW-14	694.30	693.70	NM	---	NM	---	NM	---	NM	---
MW-15**	696.30	698.97	NM	---	NM	---	NM	---	13.05	685.92
MW-16	696.30	698.36	NM	---	NM	---	NM	---	NM	---
TF-1	697.53	699.31	15.84	683.47	15.98	683.33	15.9	683.41	15.97	683.34
TF-2	696.82	698.00	17.05	680.95	17.14	680.86	17.05	680.95	17.07	680.93
TF-3	697.61	699.64	18.00	681.64	18.13	681.51	18.01	681.63	18.10	681.54
TF-4	697.52	699.18	NM	---	NM	---	NM	---	16.12	683.06

Notes:

TOC = top of casing

BOW = bottom of well

NM = not measured

* = MW-11 TOC elevation re-surveyed September

2010 after repair to well casing.

Previous TOC = 689.9, re-surveyed TOC = 692.2.

All groundwater elevations prior to September 2010

are based on the previous survey.

** = Deep Monitoring Well - not used for groundwater contours.

Groundwater sampling program began with the March 2009 event

Groundwater Elevations July 2004 through September 2010
Based on January 2006 Re-Survey
PPG Industries, Inc., Oak Creek, Wisconsin

Monitoring Well ID	Ground Elevation (msl)	TOC Elevation* (msl)	July 2006		November 2006		February 2007		July 2007	
			Depth to Water (TOC)	Ground-water Elevation	Depth to Water (TOC)	Ground-water Elevation	Depth to Water (TOC)	Ground-water Elevation	Depth to Water (TOC)	Ground-water Elevation
LP-2**	696.83	697.79	14.4	683.39	11.77	686.02	9.87	687.92	NM	---
LP-3	695.84	696.18	12.11	684.07	9.94	686.24	9.87	686.31	NM	---
LW-2	697.34	698.62	11.64	686.98	11.26	687.36	10.41	688.21	9.43	689.19
LW-3	695.76	696.39	12.4	683.99	11.67	684.72	7.62	688.77	NM	---
LW-5	695.79	698.40	15.75	682.65	12.89	685.51	9.91	688.49	9.69	688.71
LW-6	695.61	698.19	13.88	684.31	12.66	685.53	9.74	688.45	9.48	688.71
MW-10	693.18	696.43	9.18	687.25	9.47	686.96	11.26	685.17	10.09	686.34
MW-11	689.20	692.20	6.43	685.17	5.18	686.42	6.96	684.64	7.57	684.03
MW-12	685.60	687.92	8.31	679.61	5.49	682.43	7.40	680.52	9.02	678.9
MW-13	683.80	686.35	6.48	679.87	5.10	681.25	6.05	680.3	NM	---
MW-14	694.30	693.70	6.77	686.93	6.10	687.6	6.99	686.71	6.15	687.55
MW-15**	696.30	698.97	12.54	686.43	12.09	686.88	12.05	686.92	NM	---
MW-16	696.30	698.36	NM	---	NM	---	NM	---	NM	---
TF-1	697.53	699.31	15.9	683.41	13.75	685.56	10.60	688.71	10.54	688.77
TF-2	696.82	698.00	17.1	680.9	12.38	685.62	9.28	688.72	9.09	688.91
TF-3	697.61	699.64	18.05	681.59	14.00	685.64	10.90	688.74	10.99	688.65
TF-4	697.52	699.18	15.62	683.56	13.26	685.92	10.42	688.76	NM	---

Notes:

TOC = top of casing

BOW = bottom of well

NM = not measured

* = MW-11 TOC elevation re-surveyed September

2010 after repair to well casing.

Previous TOC = 689.9, re-surveyed TOC = 692.2.

All groundwater elevations prior to September 2010

are based on the previous survey.

** = Deep Monitoring Well - not used for

groundwater contours.

Groundwater sampling program began with the March 2009 event

Groundwater Elevations July 2004 through September 2010
Based on January 2006 Re-Survey
PPG Industries, Inc., Oak Creek, Wisconsin

Monitoring Well ID	Ground Elevation (msl)	TOC Elevation* (msl)	September 2007		December 2007		March 2008		June 2008	
			Depth to Water (TOC)	Ground-water Elevation	Depth to Water (TOC)	Ground-water Elevation	Depth to Water (TOC)	Ground-water Elevation	Depth to Water (TOC)	Ground-water Elevation
LP-2**	696.83	697.79	9.24	688.55	9.35	688.44	8.57	689.22	9.09	688.7
LP-3	695.84	696.18	8.84	687.34	8.95	687.23	8.83	687.35	8.78	687.4
LW-2	697.34	698.62	9.61	689.01	10.08	688.54	9.24	689.38	9.19	689.43
LW-3	695.76	696.39	7.46	688.93	7.41	688.98	6.62	689.77	7.28	689.11
LW-5	695.79	698.40	9.68	688.72	9.59	688.81	8.35	690.05	9.21	689.19
LW-6	695.61	698.19	9.52	688.67	9.38	688.81	8.20	689.99	9.00	689.19
MW-10	693.18	696.43	9.44	686.99	10.52	685.91	8.22	688.21	9.50	686.93
MW-11	689.20	692.20	6.87	684.73	4.65	686.95	2.63	688.97	6.73	684.87
MW-12	685.60	687.92	7.62	680.3	6.97	680.95	2.70	685.22	7.18	680.74
MW-13	683.80	686.35	6.38	679.97	4.43	681.92	2.64	683.71	6.43	679.92
MW-14	694.30	693.70	6.96	686.74	5.91	687.79	5.51	688.19	5.66	688.04
MW-15**	696.30	698.97	10.82	688.15	11.24	687.73	10.86	688.11	10.44	688.53
MW-16	696.30	698.36	7.64	690.72	7.25	691.11	6.26	692.1	6.88	691.48
TF-1	697.53	699.31	10.53	688.78	10.50	688.81	9.44	689.87	10.30	689.01
TF-2	696.82	698.00	8.97	689.03	8.90	689.1	7.48	690.52	8.43	689.57
TF-3	697.61	699.64	NM	---	NM	---	10.19	689.45	11.62	688.02
TF-4	697.52	699.18	10.01	689.17	10.10	689.08	8.30	690.88	9.54	689.64

Notes:

TOC = top of casing

BOW = bottom of well

NM = not measured

* = MW-11 TOC elevation re-surveyed September

2010 after repair to well casing.

Previous TOC = 689.9, re-surveyed TOC = 692.2.

All groundwater elevations prior to September 2010

are based on the previous survey.

** = Deep Monitoring Well - not used for groundwater contours.

Groundwater sampling program began with the March 2009 event

Groundwater Elevations July 2004 through September 2010
Based on January 2006 Re-Survey
PPG Industries, Inc., Oak Creek, Wisconsin

Monitoring Well ID	Ground Elevation (msl)	TOC Elevation* (msl)	September 2008		March 2009		September 2009		March 2010		September 2010	
			Depth to Water (TOC)	Ground-water Elevation	Depth to Water (TOC)	Ground-water Elevation	Depth to Water (TOC)	Ground-water Elevation	Depth to Water (TOC)	Ground-water Elevation	Depth to Water (TOC)	Ground-water Elevation
LP-2**	696.83	697.79	9.05	688.74	9.20	688.59	8.22	689.57	7.25	690.54	8.54	689.25
LP-3	695.84	696.18	8.72	687.46	8.96	687.22	8.29	687.89	7.53	688.65	8.39	687.79
LW-2	697.34	698.62	9.43	689.19	9.62	689	8.79	689.83	7.96	690.66	9.12	689.50
LW-3	695.76	696.39	7.31	689.08	7.23	689.16	5.90	690.49	3.99	692.40	7.00	689.39
LW-5	695.79	698.40	9.27	689.13	9.18	689.22	8.52	689.88	6.91	691.49	8.97	689.43
LW-6	695.61	698.19	9.05	689.14	9.14	689.05	8.33	689.86	6.76	691.43	8.66	689.53
MW-10	693.18	696.43	9.48	686.95	10.18	686.25	9.85	686.58	4.98	691.45	9.07	687.36
MW-11	689.20	692.20	6.38	685.22	5.25	686.35	6.90	684.7	3.42	688.18	6.99	685.21
MW-12	685.60	687.92	8.41	679.51	5.09	682.83	8.43	679.49	2.94	684.98	8.01	679.91
MW-13	683.80	686.35	6.07	680.28	4.97	681.38	6.52	679.83	2.56	683.79	6.74	679.61
MW-14	694.30	693.70	5.81	687.89	6.09	687.61	5.81	687.89	5.14	688.56	5.38	688.32
MW-15**	696.30	698.97	10.53	688.44	11.03	687.94	10.65	688.32	10.51	688.46	10.17	688.80
MW-16	696.30	698.36	6.67	691.69	7.13	691.23	6.97	691.39	6.97	691.39	6.91	691.45
TF-1	697.53	699.31	10.31	689.00	10.18	689.13	8.98	690.33	6.89	692.42	9.21	690.10
TF-2	696.82	698.00	8.61	689.39	8.45	689.55	7.80	690.2	5.66	692.34	8.11	689.89
TF-3	697.61	699.64	11.2	688.44	10.70	688.94	9.26	690.38	6.85	692.79	10.38	689.26
TF-4	697.52	699.18	9.63	689.55	9.58	689.60	8.87	690.31	7.15	692.03	9.40	689.78

Notes:

TOC = top of casing

BOW = bottom of well

NM = not measured

* = MW-11 TOC elevation re-surveyed September 2010 after repair to well casing.

Previous TOC = 689.9, re-surveyed TOC = 692.2.

All groundwater elevations prior to September 2010 are based on the previous survey.

** = Deep Monitoring Well - not used for groundwater contours.

Groundwater sampling program began with the March 2009 event

TF-3 Free Product Removal Summary
PPG Industries, Inc., Oak Creek, Wisconsin

Date	Depth to Free Product (feet)	Depth to Groundwater (feet)	Free Product Thickness (feet)	Approximate Volume of Liquid Removed (gallons)	Approximate Cumulative Volume of Liquid Removed (gallons)
3/13/2009	10.15	10.19	0.04	10	10
3/16/2009	10.25	10.43	0.18	10	20
3/23/2009	10.4	10.8	0.4	10	30
3/27/2009	10.55	10.7	0.15	8	38
4/3/2009	10.1	10.28	0.18	7	45
4/15/2009	10.54	11.08	0.54	8	53
4/17/2009	10.66	10.75	0.09	8	61
4/21/2009	9.8	9.8	0	0	61
4/26/2009	8.86	8.87	0.01	8	69
5/6/2009	10.22	10.99	0.77	8	77
5/11/2009	10.25	10.48	0.23	8	85
5/20/2009	10.41	10.63	0.22	8	93
5/28/2009	10	10.15	0.15	8	101
6/4/2009	10.6	10.76	0.16	8	109
6/10/2009	9.78	9.8	0.02	8	117
6/18/2009	10.31	10.4	0.09	8	125
6/25/2009	9.98	10.09	0.11	0	125
7/7/2009	10.52	11	0.48	5	130
7/17/2009	10.2	10.56	0.36	4	134
7/23/2009	10.66	10.73	0.07	0	134
7/30/2009	10.76	10.84	0.08	0	134
8/6/2009	10.83	11.05	0.22	4	138
8/13/2009	9.95	9.96	0.01	0	138
8/20/2009	9.09	9.19	0.1	0	138
8/27/2009	8.19	8.21	0.02	0	138
9/3/2009	9.45	9.48	0.03	0	138
9/16/2009	9.98	10.3	0.32	4	142
9/23/2009	9.2	9.2	0	0	142
10/8/2009	8.92	8.93	0.01	0	142
10/15/2009	9.1	9.11	0.01	0	142
10/22/2009	8.32	8.33	0.01	0	142
10/29/2009	7.71	7.71	0	0	142
11/13/2009	7.8	7.8	0	0	142
11/19/2009	7.45	7.45	0	0	142
12/3/2009	8.91	8.92	0.01	0	142
12/11/2009	8.15	8.16	0.01	0	142
12/17/2009	9.15	9.18	0.03	0	142
1/7/2010	8.9	8.93	0.03	0	142
1/15/2010	9.12	9.2	0.08	0	142
1/21/2010	9.4	9.55	0.15	0	142
2/2/2010	9.05	9.06	0.01	0	142
2/11/2010	9.14	9.2	0.06	0	142
2/25/2010	8.75	8.81	0.06	0	142
3/4/2010	9	9.09	0.09	2	144
3/10/2010	<i>See Note 1</i>	6.85	0.00	0	144
3/19/2010	7.93	7.94	0.01	0	144

TF-3 Free Product Removal Summary
PPG Industries, Inc., Oak Creek, Wisconsin

Date	Depth to Free Product (feet)	Depth to Groundwater (feet)	Free Product Thickness (feet)	Approximate Volume of Liquid Removed (gallons)	Approximate Cumulative Volume of Liquid Removed (gallons)
3/31/2010	9.1	9.2	0.1	0	144
4/9/2010	7.26	7.29	0.03	0	144
4/15/2010	8.54	8.58	0.04	0	144
4/22/2010	10.46	10.79	0.33	3	147
4/30/2010	10.4	10.57	0.17	2	149
5/5/2010	10.58	10.7	0.12	0	149
5/18/2010	10.15	10.22	0.07	0	149
5/27/2010	10.48	10.86	0.38	2	151
6/9/2010	9.47	9.55	0.08	0	151
6/17/2010	10.37	10.71	0.34	3	154
7/14/2010	10.3	10.8	0.5	2	156
7/29/2010	9.95	10.36	0.41	3	159
8/13/2010	10.19	11.04	0.85	3	162
8/26/2010	10.45	10.66	0.21	2	164
9/8/2010	10.45	10.53	0.08	0	164
<i>9/14/2010</i>	<i>10.36</i>	<i>10.38</i>	<i>0.02</i>	<i>0</i>	<i>164</i>

1. No measureable product detected.
 Entries in italic font indicate dates of groundwater sampling events

O:\Project\PPG\119637\119637B16.dwg
 Plot Date/Time: 06/16/09 01:51pm
 Plotted by: bernadette.oconnor

OFFICE: Pittsburgh, PA
 DRAWN BY: B. Faison
 CHECKED BY: S. Furlong
 APPROVED BY: [Signature]
 DRAWING NUMBER: 119637-B18

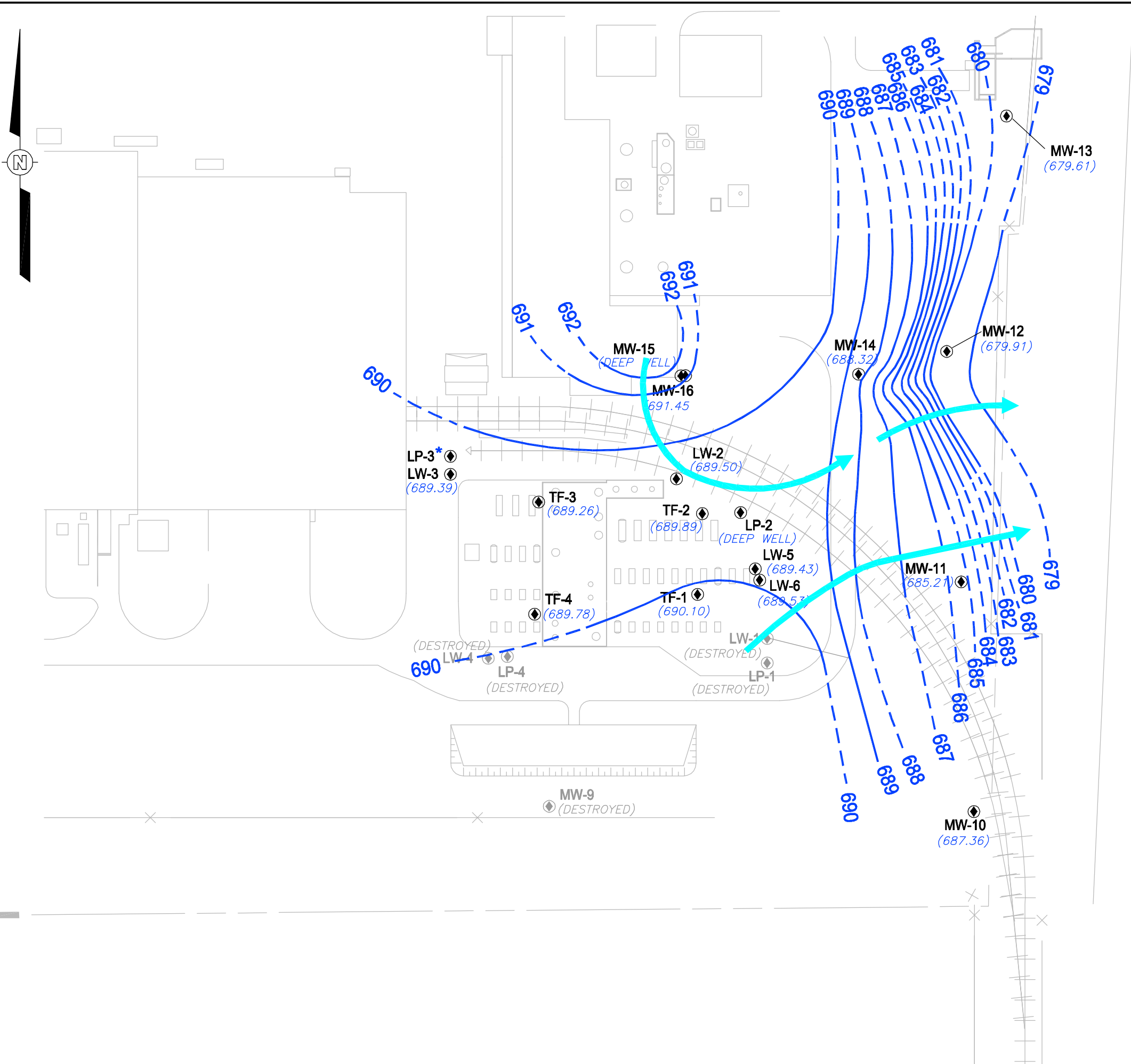

LEGEND:

- MONITORING WELL LOCATIONS
- GROUNDWATER ELEVATION (MSL)
- GROUNDWATER CONTOUR (DASHED WHERE INFERRED)
- DIRECTION OF GROUNDWATER FLOW

- NOTES:**
1. WATER ELEVATIONS WERE GAUGED AT SOME DEEP WELLS BUT THE GROUND-WATER ELEVATIONS ARE NOT PROVIDED ON THE MAP BECAUSE THESE DATA ARE NOT USED FOR CONTOURING.
 2. BASED ON WATER LEVELS MEASURED SEPTEMBER 14, 2010.
 3. DEEP WELLS (MW-15 AND LP-2) NOT USED FOR CONTOURING PURPOSES.
 4. * LP-3 NOT USED FOR CONTOURING PURPOSES SINCE IT IS SCREENED FROM 30-35'.



Shaw Shaw Environmental, Inc.

PPG INDUSTRIES, INC.
 OAK CREEK, WISCONSIN

FIGURE 1
GROUNDWATER ELEVATION MAP
 SEPTEMBER 14, 2010
 HYDROGEOLOGIC EVALUATION
 OAK CREEK, WISCONSIN