

APPENDIX A

FIELD ACTIVITY LOGS
Recent Facility Monitoring Daily Activity Logs

PPG

12 Location Oak Creek, WI Date 7/26/04

Project / Client PPG Industries
826003

ON OFF

Show: CJZ, STP 9:45 2:30

Job: GW Sample

Equip: WLT, Wheel Pump, Tubing, Battery
Two drums, Metal Detector, Bailers

Weather Sunny, 70's

Well	TOC to water	TOC to BAW	V pump	V pump	Time
MW-12	2.03	14.53	5	5	10:30
MW-11	6.47	17.63	8	8	10:45
MW-10	(Could Not Sample)		—	—	—
LW-6	14.06	25.13	8	8	12:00
LW-5	15.54	17.98	2	1-1.5 dry	11:45
LW-2	12.25	18.48	5	5	11:00
TF-2	17.05	18.65	3	2 little H ₂ O	11:30
TF-1	15.84	18.68	2	4 dark color	12:30
TF-3	18.00	21.01	6	5 dry	1:00
LW-60	Duplicate VOC Sample of LW-6				12:15
DECON					13:00
TRIP Blank					10:00

MW-10 damaged. Stand pipe completely bent over, PVC crimped/cracked. Well will need to be fixed w/ new pipe, PVC, and cement pad.

Location _____ Date 7/26/04 13

Project / Client _____

Site Map

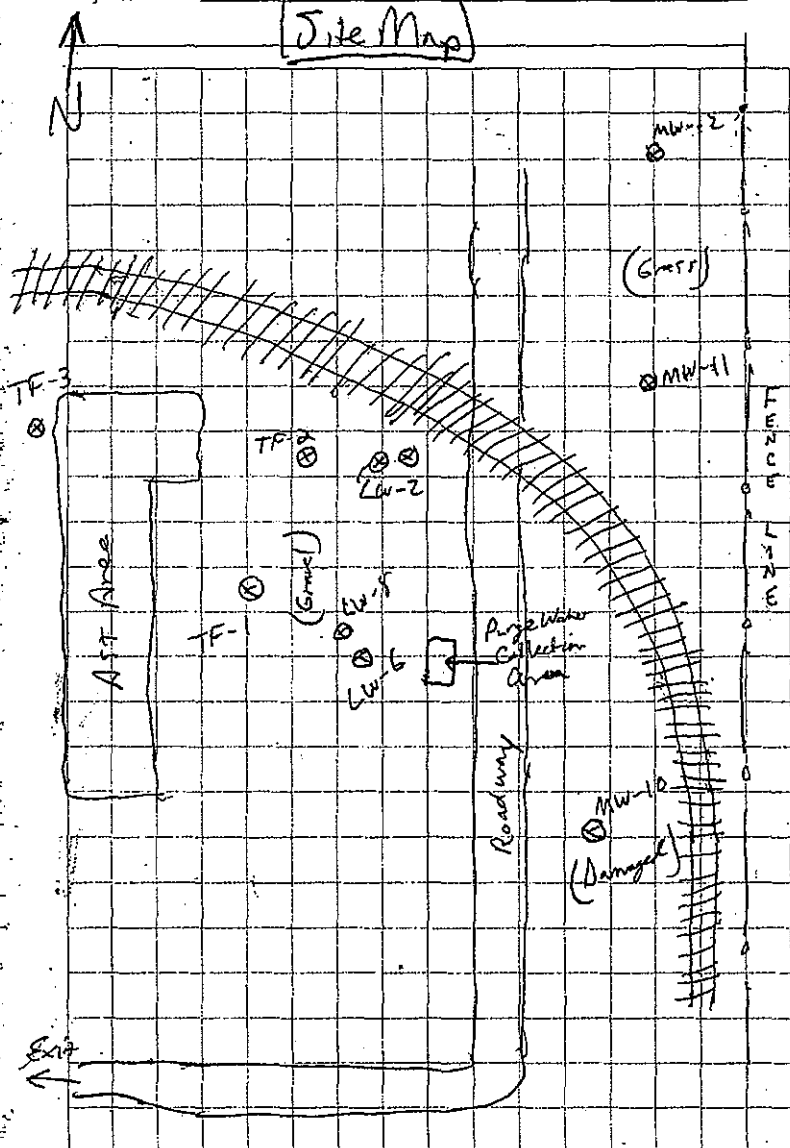

CJZ 7-26-04

COC No. A 48063

156 Starlite Drive
Marietta, OH 45750



CHAIN-OF-CUSTODY RECORD

Phone: 740-373-4071

Fax: 740-373-4835

Company Name: <i>Shaw Environmental, Inc.</i>							NUMBER OF CONTAINERS	Hold	<i>VOC (method 8260B)</i>										
Project Contact: <i>PAUL LAMBERT</i>				Contact Phone #: <i>312-499-3536</i>															
Turn Around Requirements:				Location: <i>Oak Creek, WI</i>															
Project #: <i>826003</i>				Project Name: <i>PPG</i>															
Sampler (print): <i>Chuck Zimney</i> <i>Scott Petlewski</i>				Signature: <i>Chuck Zimney</i>															
Sample I.D. No.	Comp*	Grab	Date	Time	Protocol		NUMBER OF CONTAINERS	Hold											
					CWA	SW846													
<i>MW-12</i>		<i>X</i>	<i>7/26/04</i>	<i>10:30</i>			<i>3</i>	<i>✓</i>											
<i>MW-11</i>		<i>X</i>		<i>10:45</i>			<i>3</i>	<i>✓</i>											
<i>LW-2</i>		<i>X</i>		<i>11:00</i>			<i>3</i>	<i>✓</i>											
<i>TF-2</i>		<i>X</i>		<i>11:30</i>			<i>3</i>	<i>✓</i>											
<i>LW-5</i>		<i>X</i>		<i>11:45</i>			<i>3</i>	<i>✓</i>											
<i>LW-60</i>		<i>X</i>		<i>12:15</i>			<i>3</i>	<i>✓</i>											
<i>LW-6</i>		<i>X</i>		<i>12:00</i>			<i>3</i>	<i>✓</i>											
<i>TF-1</i>		<i>X</i>		<i>12:30</i>			<i>3</i>	<i>✓</i>											
<i>TF-3</i>		<i>X</i>		<i>13:00</i>			<i>3</i>	<i>✓</i>											
<i>DECON.</i>		<i>X</i>		<i>13:30</i>			<i>3</i>	<i>✓</i>											
<i>Trip Blanks</i>		<i>X</i>	<i>✓</i>	<i>10:00</i>			<i>3</i>	<i>✓</i>											
Relinquished by: (Signature) <i>Chuck Zimney</i>			Date <i>7/26/04</i>	Time <i>17:00</i>	Received by: (Signature)			Relinquished by: (Signature)			Date	Time	Received by: (Signature)						
Relinquished by: (Signature)			Date	Time	Received for Laboratory by: (Signature)			Date	Time	Cooler Temp in °C	Remarks:								

- Program
- NPDES
 - AFCEE
 - RCRA
 - USAGE
 - Other *UST*

ADDITIONAL REQUIREMENTS

*Homogenize all composite samples prior to analysis

Location Oak Creek, WI Date 1/31/05Project / Client PPG826003ON OFF
8:30 12:45

Shaw = CJZ/STP

JOB: SW Sample

Equip: WLF, Whale Pump, Bailers, Battery

Well	TOC to water	TOC to BOW	Vump	Vumped	Time
MW-12	6.44	14.59	6	6	9:00
MW-11	6.87	17.63	6	6	9:30
LW-6	14.49	25.12	7	6 (dry)	10:45
LW-5	15.49	17.99	2	2	11:00
LW-2	13.76	18.48	4	4	10:00
TF-2	17.14	18.69	3	2 (dry)	10:15
TF-1	15.98	18.68	2	3	12:00
TF-3	18.13	21.12	6	4 (dry)	11:30
LW-60	(Duplicate of LW-6)				11:00
DECON					12:15
TRIP					8:00

Cord in MW-12, stuck in place

TF-3 Strong Odor, turbid samples

TF-2 Slow recharge, turbid sample

(826-BETX)

Location _____ Date 1/31/05

Project / Client _____

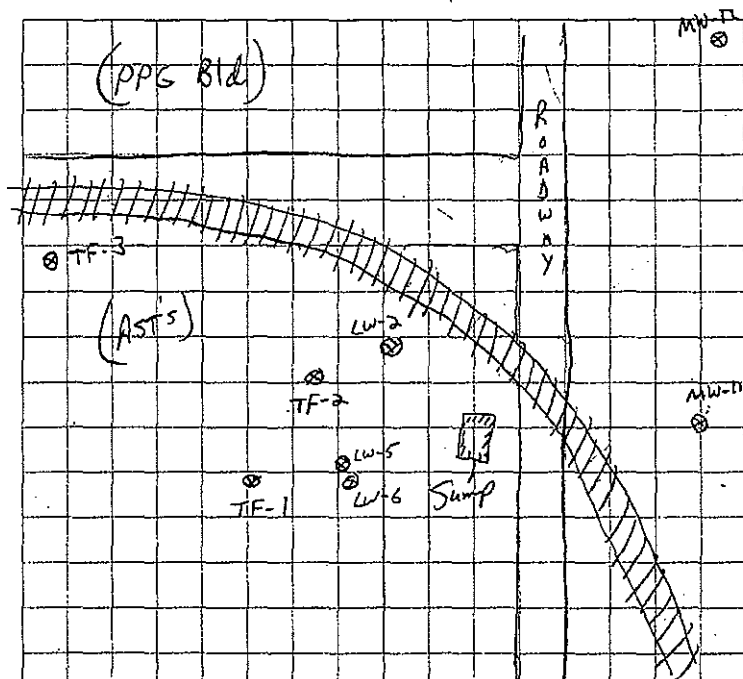

- 76008 Master Locks on wells

- Poured purge water down shump, per Steve Fedewa

- MW-10 still damaged/bent

CJZ 1/31/05

COC No. A 50814

156 Starlite Drive
Marietta, OH 45750



ENVIRONMENTAL SERVICES

CHAIN-OF-CUSTODY RECORD

Phone: 740-373-4071

Fax: 740-373-4835

Company Name: Shaw E + I		Project Contact: PAUL LAMBERT		Contact Phone #: 312-499-3536		NUMBER OF CONTAINERS	Hold	826-BETX											Program <input type="checkbox"/> NPDES <input type="checkbox"/> AFCEE <input type="checkbox"/> RCRA <input type="checkbox"/> USAGE <input type="checkbox"/> Other _____		
Turn Around Requirements:		Location: Oak Creek, WI		Project Name: PPG															ADDITIONAL REQUIREMENTS		
Project #: 826003		Sampler (print): Chuck Zimny / Scott Petlewski		Signature: <i>Chuck Zimny</i>																	
Sample I.D. No.	Comp*	Grab	Date	Time	CWA				SW846												
MW-12		✓	1/31/05	9:00			2	✓													
MW-11		✓		9:30			2	✓													
LW-2		✓		10:00			2	✓													
TF-2		✓		10:15			2	✓													
LW-6		✓		10:45			2	✓													
LW-5		✓		11:00			2	✓													
LW-60		✓		11:00			2	✓													
TF-3		✓		11:30			2	✓	Strong Odor												
TF-1		✓		12:00			2	✓													
DECA		✓		12:15			2	✓													
TRIP Blank		✓	✓	8:00			2	✓	Original trip blanks from Kemron broken during shipping												
Relinquished by: (Signature) <i>Chuck Zimny</i>		Date	Time	Received by: (Signature)		Relinquished by: (Signature)		Date	Time	Received by: (Signature)											
Relinquished by: (Signature)		Date	Time	Received for Laboratory by: (Signature)		Date	Time	Cooler Temp in °C	Remarks:												

*Homogenize all composite samples prior to analysis

Shaw: CJZ STP

Job: Gw Sample

Equip: WLI, Whole Pump, Battery, Bailers

PPG: Steve Fedewa

Well	TOC to Water	TOC to Bowl	V _{pump}	V _{pumped}	Time
MW-12	9.74	14.59	4	4	8:30
MW-11	8.00	17.63	7	7	9:00
LW-6	14.13	25.13	8	7 (dry)	9:30
LW-5	15.62	18.07	2	1 (dry)	10:00
LW-2	14.33	18.48	3	2 (dry)	10:30
TF-2	17.05	18.66	1.5	1.5	10:50
TF-1	15.90	18.66	2.5	2.5	11:10
TF-3	18.01	21.12	2.5	2.5	11:30
LW-60	(Duplicate of LW-6)				9:45
DECON					11:45
Trip Blank					8:00

MW-11 → Turbid brown

LW-5 → Turbid, blackish color

TF-3 → Strong odor, turbid-blackish color

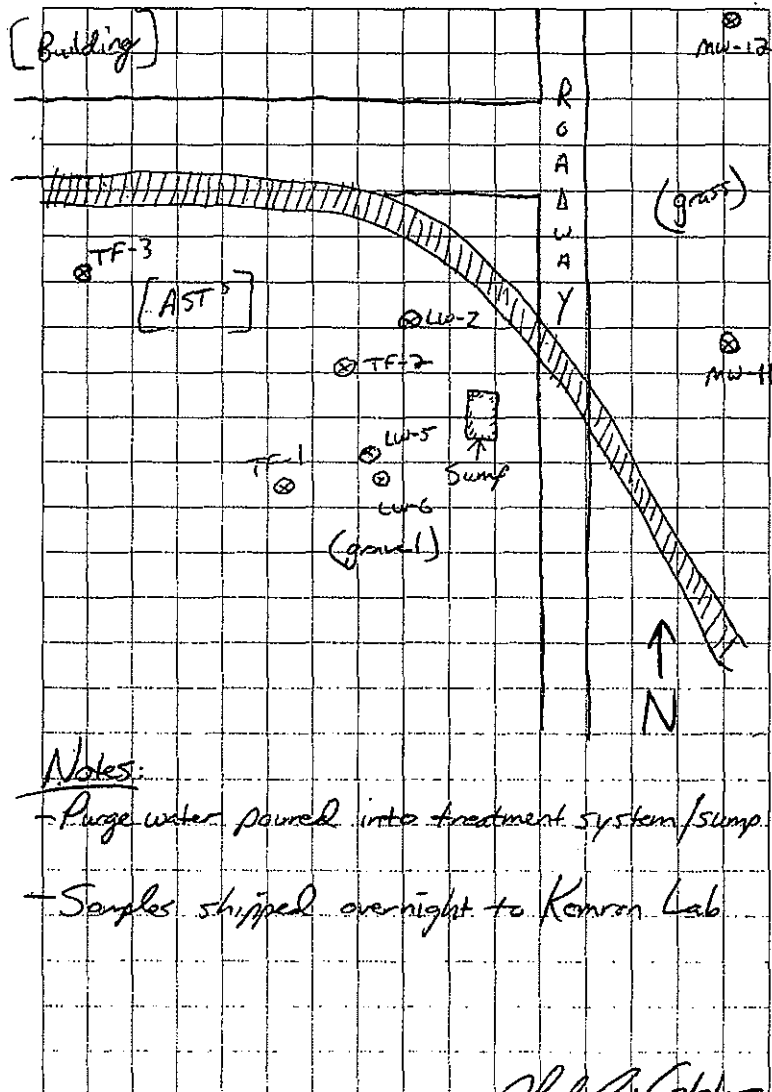
Notes:

- Purge water poured into treatment system/sump

- Samples shipped overnight to Kenron Lab

Steve Fedewa

COC No. A 54799

156 Starlite Drive
Marietta, OH 45750

KEMRON
ENVIRONMENTAL SERVICES
CHAIN-OF-CUSTODY RECORD

Phone: 740-373-4071
Fax: 740-373-4835

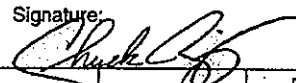
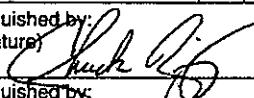
Company Name: Shaw E+I						NUMBER OF CONTAINERS Hold 826-BETX												Program <input type="checkbox"/> NPDES <input type="checkbox"/> AFCEE <input type="checkbox"/> RCRA <input type="checkbox"/> USAGE <input type="checkbox"/> Other _____															
Project Contact: PAUL LAMBERT			Contact Phone #: 312-499-3536																											ADDITIONAL REQUIREMENTS			
Turn Around Requirements:			Location: Oak Creek, WI																														
Project #: 826003			Project Name: PPG																														
Sampler (print): Chuck Zimney						Signature: 																											
Sample I.D. No.	Comp*	Grab	Date	Time	Protocol		NUMBER OF CONTAINERS	Hold																									
					CWA	SW846																											
MW-12		✓	7-8-05	8:30			2	✓																									
MW-11		✓		9:00			2	✓																									
LW-6		✓		9:30			2	✓																									
LW-60		✓		9:45			2	✓																									
LW-5		✓		10:00			2	✓																									
LW-2		✓		10:30			2	✓																									
TF-2		✓		10:50			2	✓																									
TF-1		✓		11:10			2	✓																									
TF-3		✓		11:30			2	✓																									
DECON		✓		11:45			2	✓																									
TRIP Blank		✓	↓	8:00			2	✓																									
Relinquished by: 			Date: 7-8-05	Time: 14:00	Received by: _____			Relinquished by: _____			Date	Time	Received by: _____																				
Relinquished by: _____			Date	Time	Received for Laboratory by: _____			Date	Time	Cooler Temp in °C	Remarks:																						

*Homogenize all composite samples prior to analysis

Location Oak Creek, WI Date 1/23/06Project / Client PPG
826003

SHAW: CTZ, CAP ON OFF
10:15 16:45
Job: GW Sample + Survey
Equip: WLE, White Pump, Survey Gear

Well	TOC to water	TOC to ROW	V _{ump}	V _{umped}	Time
mw-12	5.44	14.59	8	8	11:15
mw-11	5.40	17.63	9	9	11:45
LW-6	14.26	25.15	7	7	12:15
LW-5	15.75	18.03	2	0.5 (dry)	12:30
LW-2	12.87	18.48	6	4 (dry)	13:15
TF-2	17.07	18.68	4	2.5	13:45
TF-1	15.97	18.70	4	.5 (dry)	14:30
TF-3*	18.10	21.12	4	4	14:00
LW-50	(Duplicate of LW-5)				12:40
TRIP Blank					8:00

Groundwater TOC Data (other wells)

WELL	TOC to H ₂ O	TOC to ROW
mw-15	13.05	37.15
LP-2	14.55	33.70
TF-4	16.12	21.07
LP-3	12.77	34.15
LW-3	12.70	14.93

* = odor in well

Location _____ Date 1/23/06

Project / Client _____

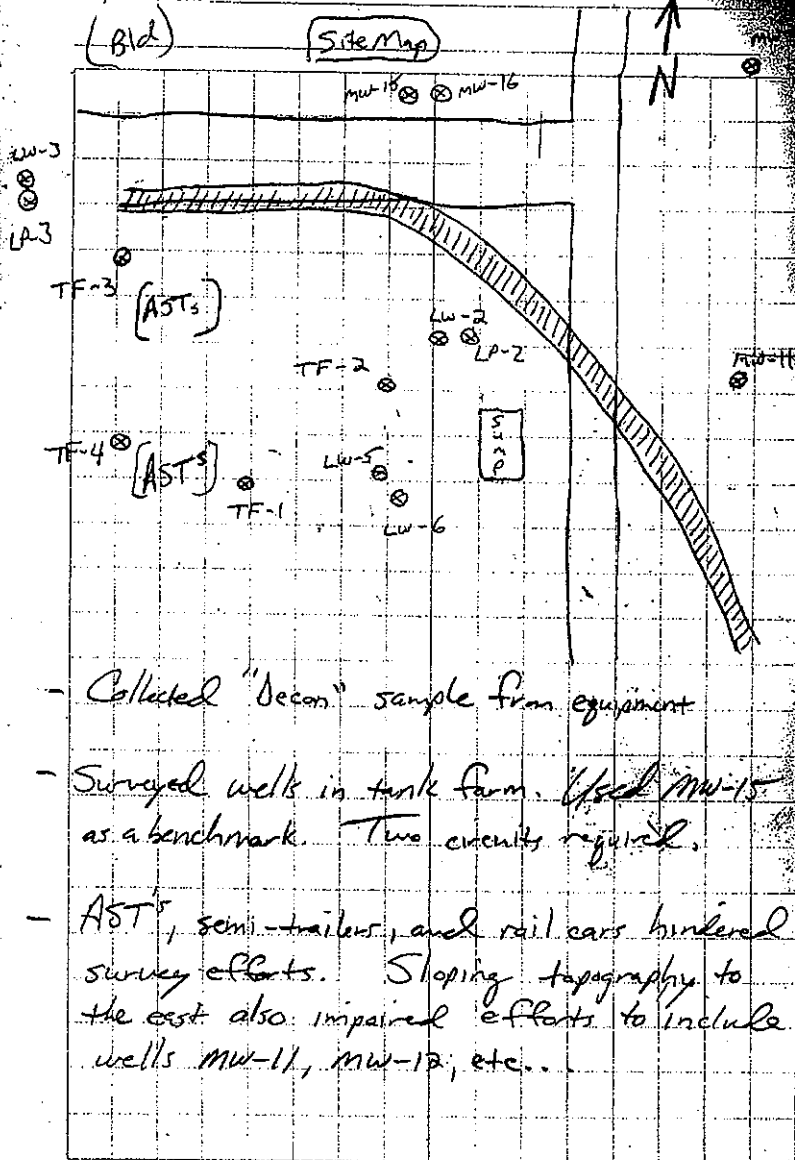

- Collected "Decon" sample from equipment
- Surveyed wells in tank farm. Used MW-15 as a benchmark. Two events rejected.
- ASTs, semi-trailers, and rail cars hindered survey efforts. Sloping topography to the east also impaired efforts to include wells mw-11, mw-12, etc.

Location _____

Date _____

Project / Client _____

Survey Notes

Benchmark MW-15

Initial Reading → 2.92 ✓

	<u>TOC</u>	<u>Ground</u>	
LW-3	5.50	5.25	Flush Manif.
LP-3	5.71	5.30	Flush Manif.
TF-3	2.25	4.28	Standpipe
MW-15	(Bm)	5.44	"
LW-2	3.27	6.77	"
LP-2	4.10	6.82	"
TF-2	3.89	5.07	"
LW-5	3.49	6.10	"
LW-6	3.70	6.28	"
TF-1	2.58	4.36	"

Closeout MW-15 2.92 ✓

2nd Circuit

Using TF-3 as new benchmark = 699.64

Initial Reading → 2.67 + 699.64 = 702.31

	<u>TOC</u>	<u>Ground</u>	
TF-4	3.13	4.79	(Standpipe)

Closeout TF-3 = 2.67

Survey Calculations @ PPGMW-15_{TOC} = 698.97 (msl)

Hgt. Instrument = 698.97 + 2.92 = 701.89

Well

LW-3 →	701.89 - 5.50 =	696.39	TOC
	701.89 - 5.25 =	696.64	Ground
LP-3 →	701.89 - 5.71 =	696.18	TOC
	701.89 - 5.30 =	696.59	Ground
TF-3 →	701.89 - 2.25 =	699.64	TOC
	701.89 - 4.28 =	697.61	Ground
MW-15 →	701.89 - (Benchmark)		
	701.89 - 5.44 =	696.45	Ground
LW-2 →	701.89 - 3.27 =	698.62	TOC
	701.89 - 6.77 =	695.12	Ground
LP-2 →	701.89 - 4.10 =	697.79	TOC
	701.89 - 6.82 =	695.07	Ground
TF-2 →	701.89 - 3.89 =	698.00	TOC
	701.89 - 5.07 =	696.82	Ground
LW-5 →	701.89 - 3.49 =	698.40	TOC
	701.89 - 6.10 =	695.79	Ground
LW-6 →	701.89 - 3.70 =	698.19	TOC
	701.89 - 6.28 =	695.61	Ground
TF-1 →	701.89 - 2.58 =	699.31	TOC
	701.89 - 4.36 =	697.53	Ground

2nd Circuit

TF-4 →	702.31 - 3.13 =	699.18	TOC
	702.31 - 4.79 =	697.52	Ground

COC No. A 58314

156 Starlite Drive
Marietta, OH 45750



ENVIRONMENTAL SERVICES
CHAIN-OF-CUSTODY RECORD

Phone: 740-373-4071

Fax: 740-373-4835

Company Name: SHAW ENVIRONMENTAL		Project Contact: PAUL LAMBERT		Contact Phone #: 618-248-1010		NUMBER OF CONTAINERS	Hold	826 BETX											Program		
Turn Around Requirements:		Location: Oak Creek, WI		Project #: 826003					Project Name:												<input type="checkbox"/> NPDES <input type="checkbox"/> AFCEE <input type="checkbox"/> RCRA <input type="checkbox"/> USAGE <input type="checkbox"/> Other _____
Sampler (print): Chuck Zimny		Signature: 		Protocol															ADDITIONAL REQUIREMENTS		
Sample I.D. No.	Comp*	Grab	Date	Time	CWA				SW846												
MW-12		✓	1-23-06	11:15			2	✓													
MW-11		✓		11:45			2	✓													
LW-6		✓		12:15			2	✓													
LW-5		✓		12:30			2	✓													
LW-2		✓		13:15			2	✓													
TF-2		✓		13:45			2	✓													
TF-1		✓		14:30			2	✓													
TF-3		✓		14:00			2	✓													
LW-50		✓		12:40			2	✓													
REC'D		✓		14:45			2	✓													
TRIP BLANK		✓	V	8:00			2	✓													
Relinquished by (Signature): 		Date:	Time:	Received by (Signature):		Relinquished by (Signature):		Date:	Time:	Received by (Signature):											
Relinquished by (Signature):		Date:	Time:	Received for Laboratory by (Signature):		Date:	Time:	Cooler Temp in °C:	Remarks:												

*Homogenize all composite samples prior to analysis