

## 1/3 Cord Firewood Storage: T Post Ends



- Extendable to hold more wood
- Inexpensive materials
- Video instructions at:  
[www.epa.gov/burnwise/videos](http://www.epa.gov/burnwise/videos)

### Base

(2) 8-foot landscape timbers

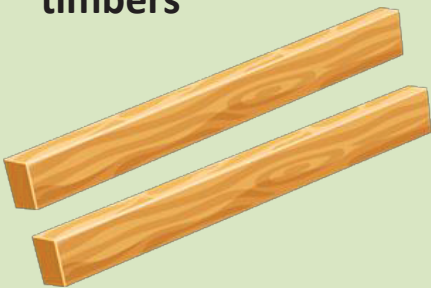

### Ends

(4) 6-foot metal T-posts



### Roof

(1) 8'X24" galvanized metal roof panel

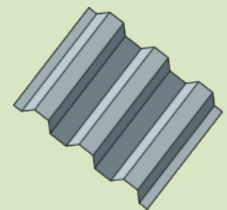

**Tools: Hammer, Safety Glasses, Gloves**

### Tips

- Slope roof to prevent water collection
- Use a large enough roof so the overhang protects wood from rain & snow
- Stack larger pieces of firewood at the base to increase stability
- Season wood at least 6 months for soft wood and 12 months for hard wood